



WWW.PALLETFORKS.COM
TITAN
ATTACHMENTS

MPN: TELBOOM

Owner's Manual



PARTS DIAGRAM & EXPLODED VIEW

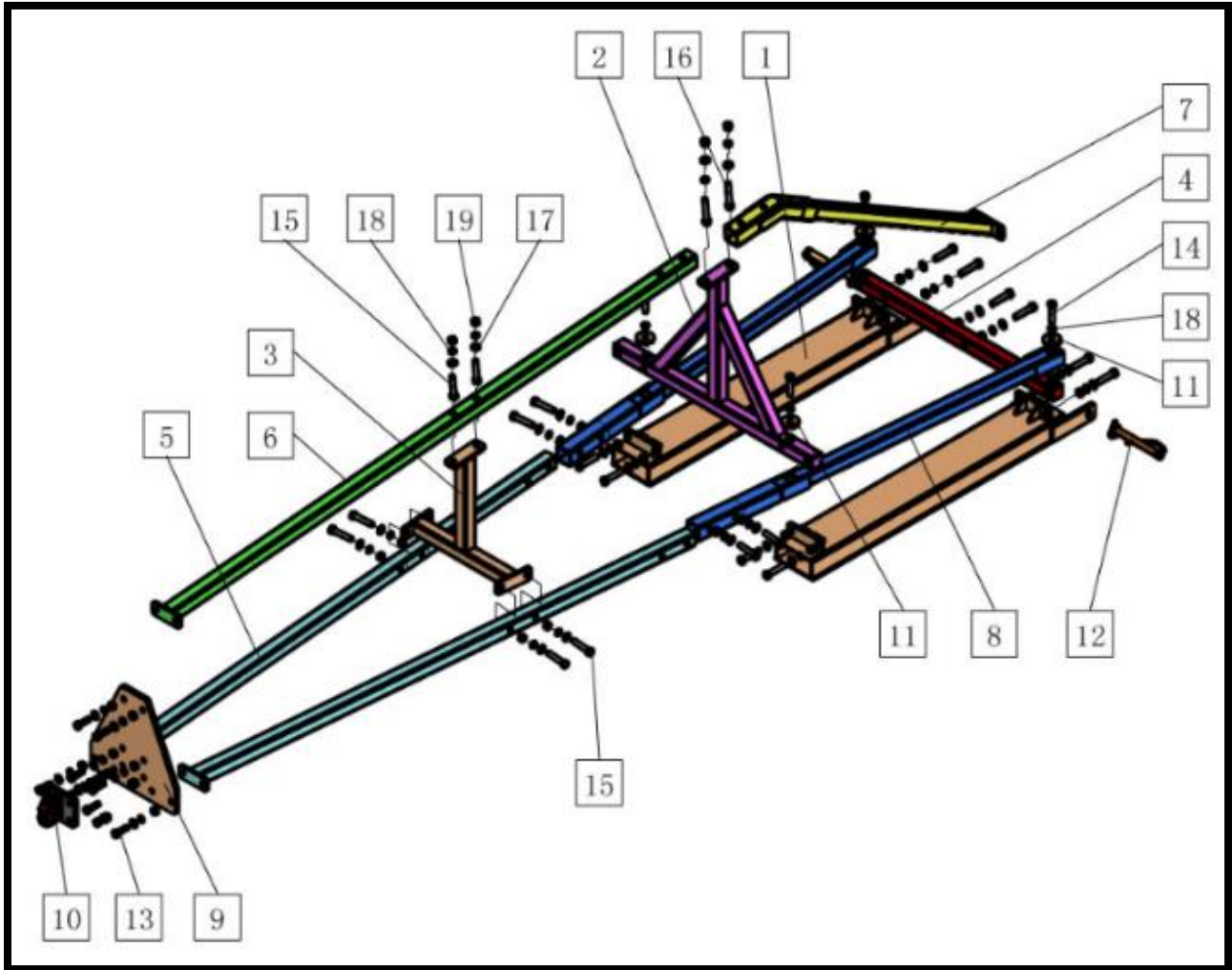

KEY #	DESCRIPTION	QTY
(1)	FORK CHANNEL	x2
(2)	SUPPORT FRAME – 1	x1
(3)	SUPPORT FRAME – 2	x1
(4)	TUBE – 1	x1
(5)	TUBE – 2	x2
(6)	TUBE – 3	x1
(7)	TUBE – 4	x1
(8)	TUBE – 5	x2
(9)	MOUNTING PLATE	x1
(10)	HOOK	x1

KEY #	DESCRIPTION	QTY
(11)	T-10mm SHIM WASHER	x4
(12)	Φ25 PIN	x2
(13)	M16x50 HEX BOLT	x10
(14)	M16x70 HEX BOLT	x4
(15)	M16x80 HEX BOLT	x20
(16)	M16x90 HEX BOLT	x2
(17)	M16 FLAT WASHER	x32
(18)	M16 SPRING WASHER	x36
(19)	M16 HEX NUT	x32

ASSEMBLY INSTRUCTIONS

IMPORTANT:

- During assembling, make sure to loosely hand-tighten all nut-and-bolt combinations.
- Once assembly is finished, tighten all nut-and-bolt combinations to stabilize the product.

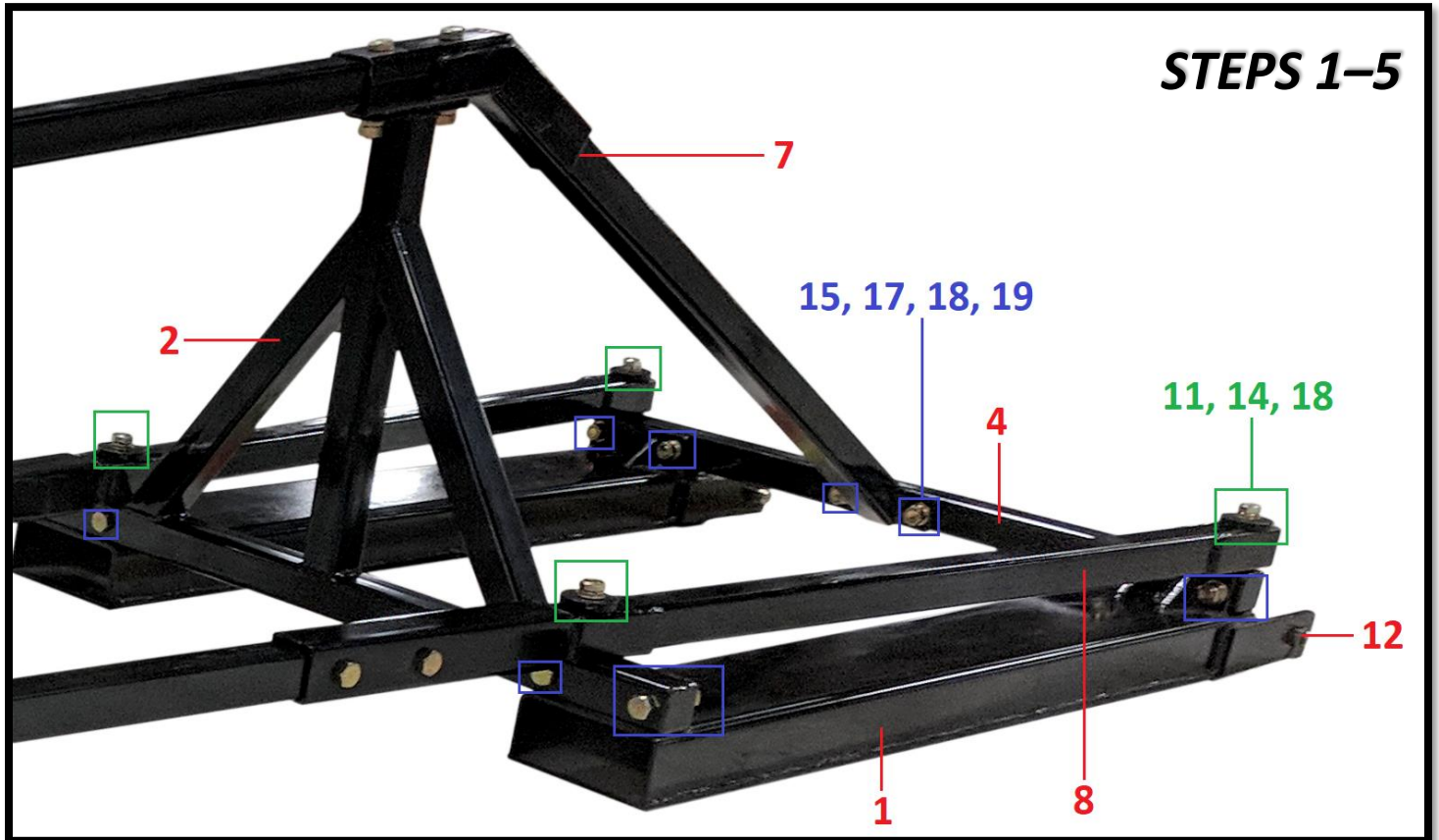

1. Lay both **FORK CHANNELS (1)** on a flat surface and insert the **Φ25 PINS (12)**.
2. Place the **SUPPORT FRAME – 1 (2)** atop the appropriate ends of both **FORK CHANNELS (1)**, and secure the **SUPPORT FRAME – 1 (2)** to the hinges of the **FORK CHANNELS (1)** using the following hardware: **M16x80 HEX BOLTS (15)**, **M16 FLAT WASHERS (17)**, **M16 SPRING WASHERS (18)**, and **M16 HEX NUTS (19)**.
3. Use the same hardware listed in the previous step to secure **TUBE – 1 (4)** to the hinges of the **FORK CHANNELS (1)**.
4. As seen in the figure above, secure each **TUBE – 5 (8)** to the ends of the **SUPPORT FRAME – 1 (2)** and the **TUBE – 1 (4)** with the following hardware: **T-10mm SHIM WASHERS (11)**, **M16x70 HEX BOLTS (14)**, and **M16 SPRING WASHERS (18)**.
5. Secure the bottom of **TUBE – 4 (7)** to the middle of **TUBE – 1 (4)** using the following hardware: **M16x80 HEX BOLTS (15)**, **M16 FLAT WASHERS (17)**, **M16 SPRING WASHERS (18)**, and **M16 HEX NUTS (19)**.

Let the top of **TUBE – 4 (7)** rest atop the **SUPPORT FRAME – 1 (2)**.

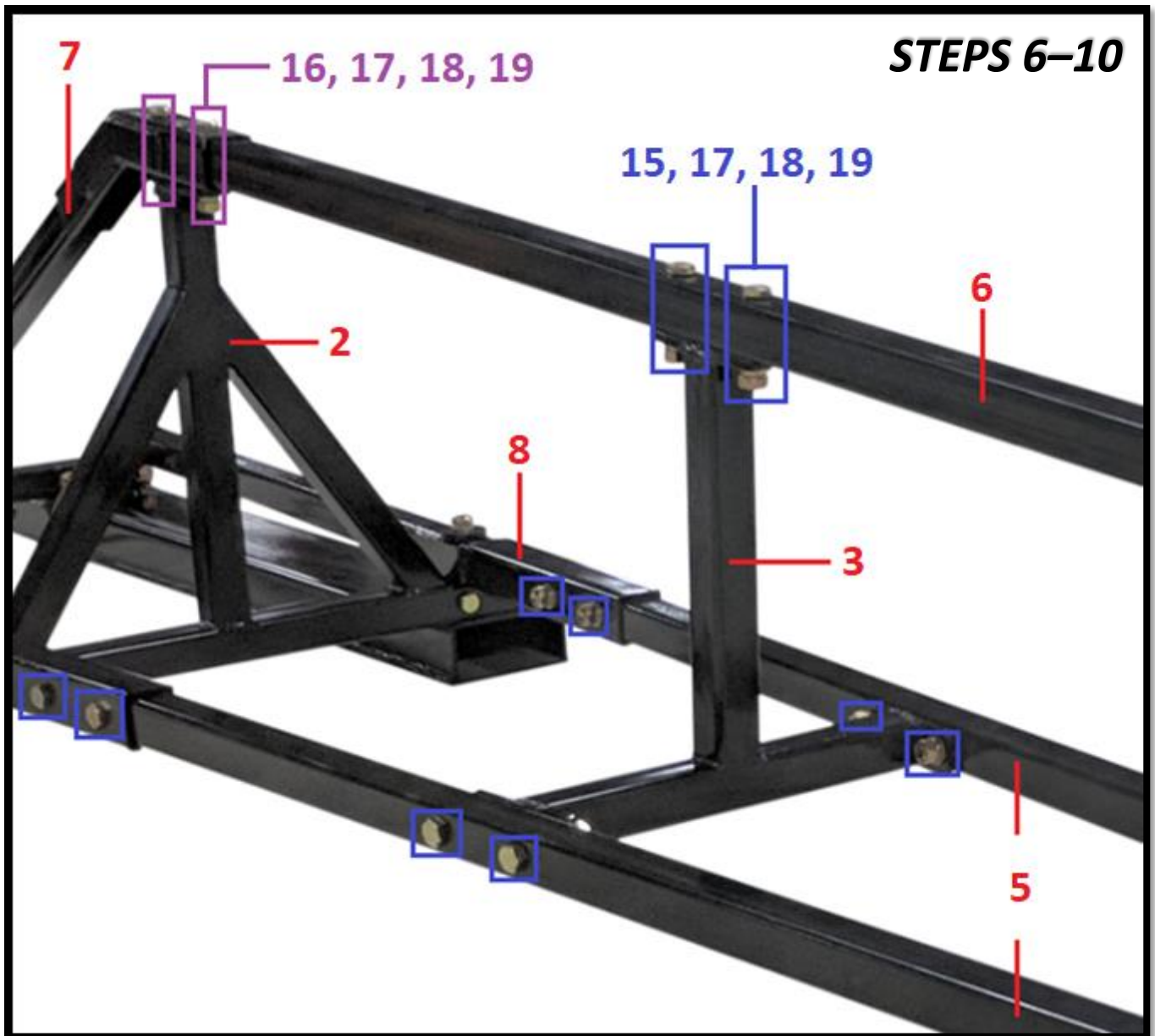

6. Slide each **TUBE – 2 (5)** into the end of each **TUBE – 5 (8)**, and secure them with the following hardware: **M16x80 HEX BOLTS (15)**, **M16 FLAT WASHERS (17)**, **M16 SPRING WASHERS (18)**, and **M16 HEX NUTS (19)**.
7. Secure the **SUPPORT FRAME – 2 (3)** to each **TUBE – 2 (5)** using the same hardware from the previous step.
8. Prop **TUBE – 3 (6)** atop the **SUPPORT FRAME – 2 (3)**, and insert one end of **TUBE – 3 (6)** into the end of **TUBE – 4 (7)**.
9. Use **M16x80 HEX BOLTS (15)**, **M16 FLAT WASHERS (17)**, **M16 SPRING WASHERS (18)**, and **M16 HEX NUTS (19)** to secure the center of **TUBE – 3 (6)** to the top of **SUPPORT FRAME – 2 (3)**.
10. Secure **TUBE – 3 (6)**, **TUBE – 4 (7)**, and **SUPPORT FRAME – 1 (2)** together with the following hardware: **M16x90 HEX BOLTS (16)**, **M16 FLAT WASHERS (17)**, **M16 SPRING WASHERS (18)**, and **M16 HEX NUTS (19)**.

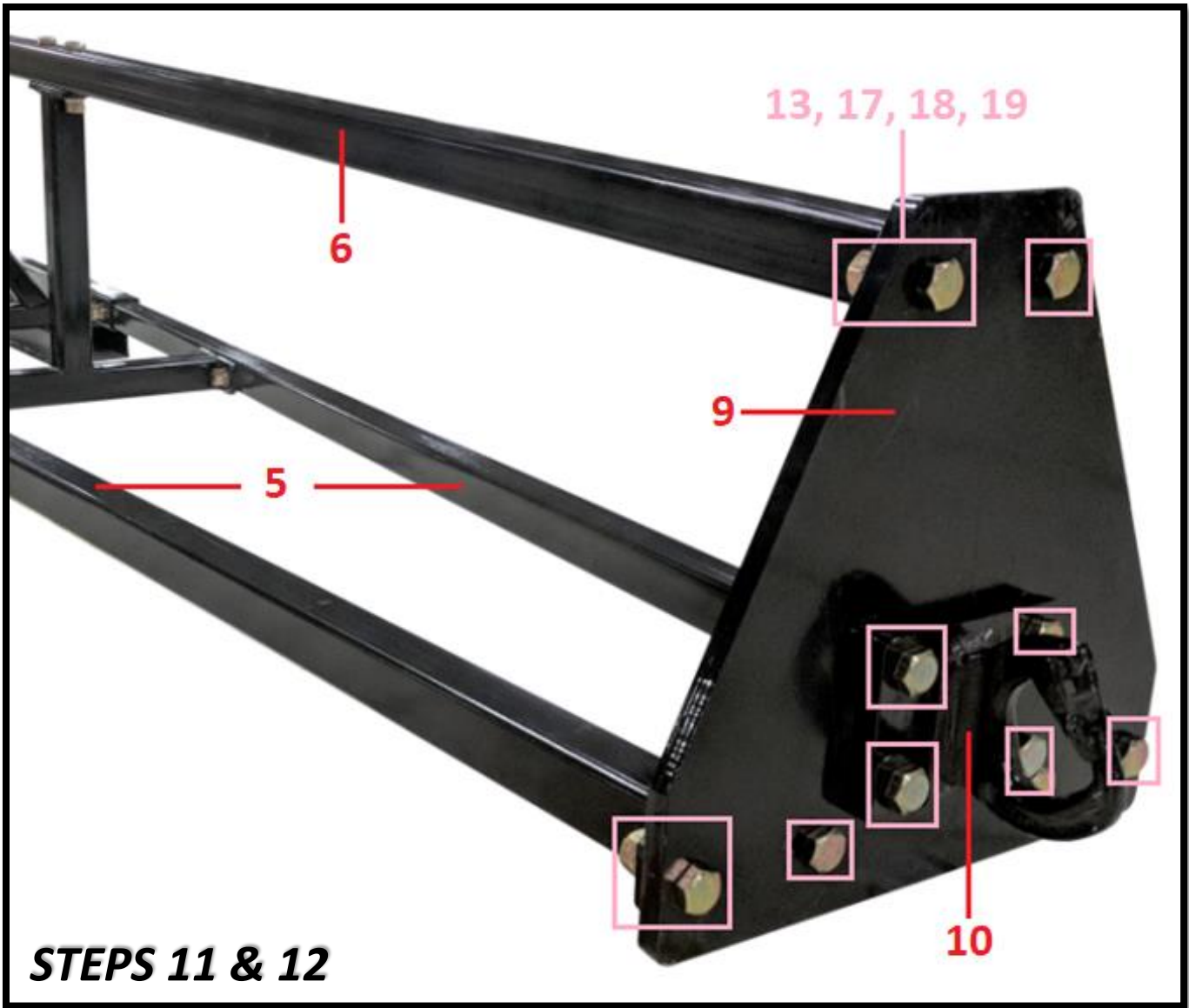

STEPS 11 & 12

11. Attach the end of each **TUBE – 2 (5)** and **TUBE – 3 (6)** to the **MOUNTING PLATE (9)** using the following hardware: **M16x50 HEX BOLTS (13)**, **M16 FLAT WASHERS (17)**, **M16 SPRING WASHERS (18)**, and **M16 HEX NUTS (19)**.
12. Secure the **HOOK (10)** to the **MOUNTING PLATE (9)** using the same hardware from the previous step.



This concludes the assembly of your product.

Make sure to tighten all nut-and-bolt combinations before use.

Enjoy!

NEED HELP?

CONTACT US FIRST.

1 (800) 605-8241

info@titandistributorsinc.com / www.palletforks.com

Business Hours: Monday–Friday • 8:00 a.m.–5:00 p.m. (CT)