



[WWW.PALLETFORKS.COM](http://WWW.PALLETFORKS.COM)

**TITAN**  
ATTACHMENTS



## OWNER'S MANUAL

---

**MPN(s): 60DISCBED**

**SKU(s): 191363**

**UPC(s): 840009210990**

# PARTS DIAGRAM / EXPLODED VIEW

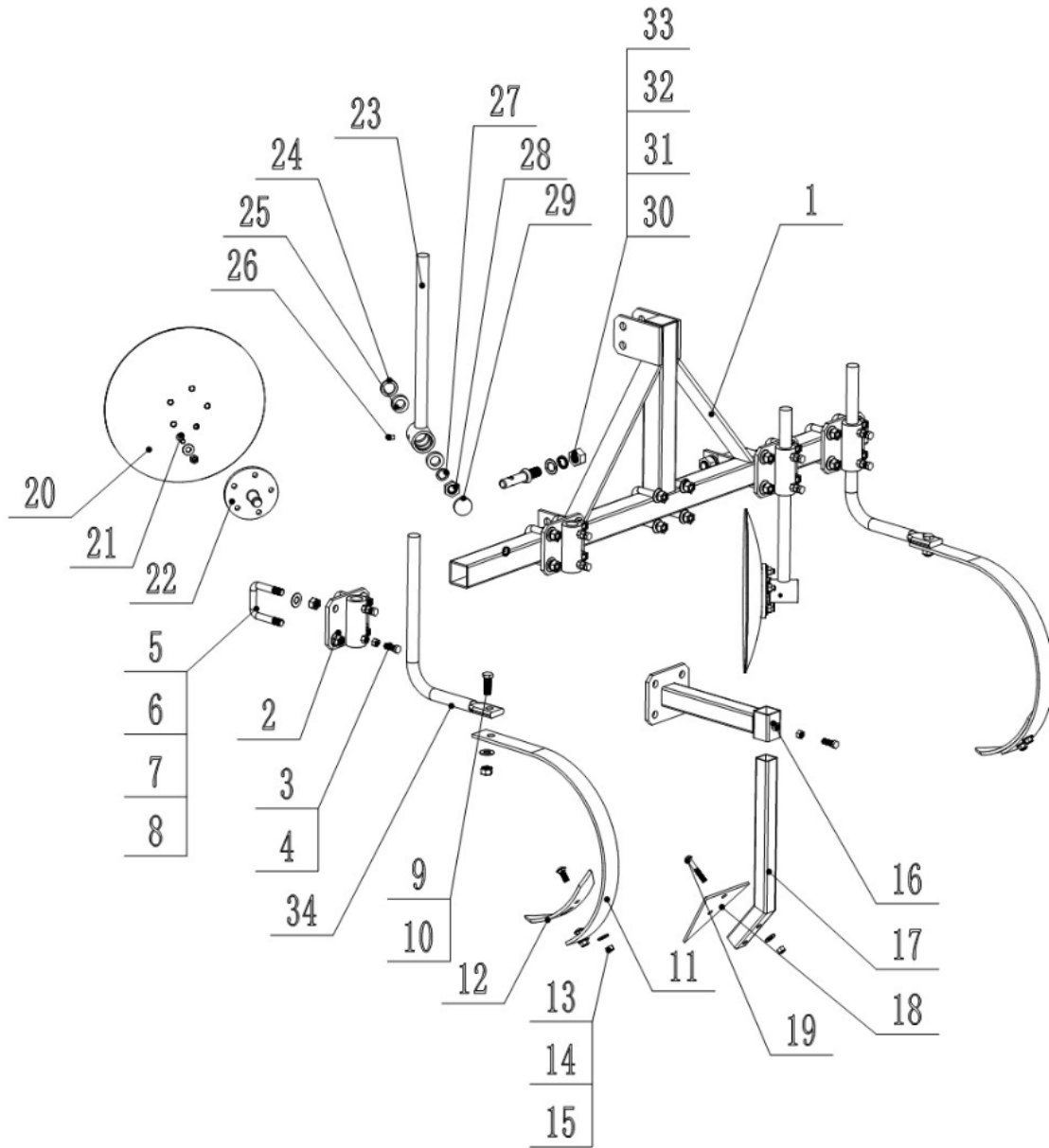

KEY	BOX	DESCRIPTION	QTY
(1)		Main Frame	1
(2)		Cushion block	2
(3)		Bolt M12*35	9
(4)		Nut M12	9
(5)		U-bolt	10
(6)		Flat washer $\Phi 16$	22



(7)		Spring washer $\Phi$ 16	20
(8)		Nut M16	20
(9)		Nut M16*45	2
(10)		Lock Nut M16	2
(11)		Spring Tooth	2
(12)		Chisel Tooth	2
(13)		Flat Head Bolt M12*30	4
(14)		Flat Washer $\Phi$ 12	14
(15)		Lock Nut M12	14
(16)		Frame A	1
(17)		Frame B	1
(18)		Tooth	1
(19)		Bolt M12*65	2
(20)		Disc	2
(21)		Bolt M12*35	10
(22)		Disc bracket	2
(23)		Brace	2
(24)		Oil seal	2
(25)		Bearing	4
(26)		Grease fitting	2
(27)		Spacer	2
(28)		Nut	2
(29)		Oil seal	2
(30)		Lift pin	2
(31)		Flat washer $\Phi$ 22	2
(32)		Spring washer $\Phi$ 22	2
(33)		Nut M22	2
(34)		Frame L	2



*This concludes the 60DISCBED Owner's Manual.  
If applicable to your product, make sure to tighten all nut-  
and-bolt combinations before use.*

*Enjoy!*

### **DISCLAIMER**

This equipment must be used with care by capable and competent individuals under supervision, if necessary.

The use of any equipment, including this one, involves the potential risk of injury. You accept and assume full responsibility for any and all injuries, damages (both economic and non-economic), and losses of any type, which may occur, and you fully and forever release and discharge Titan, its insurers, employees, officers, directors, associates, and agents from any and all claims, demands, damages, rights of action, or causes of action, present or future, whether the same be known or unknown, anticipated, or unanticipated, resulting from or arising out of the use of said equipment.

TITAN MAKES NO WARRANTY WHATSOEVER WITH RESPECT TO THE EQUIPMENT, INCLUDING ANY WARRANTY OF MERCHANTABILITY OR WARRANTY OF FITNESS FOR A PARTICULAR PURPOSE, WHETHER EXPRESS OR IMPLIED BY LAW, COURSE OF DEALING, COURSE OF PERFORMANCE, USAGE OF TRADE OR OTHERWISE. BUYER ASSUMES ALL LIABILITY IN USE OF THE EQUIPMENT.

**NEED HELP?**

**CONTACT US FIRST.**

**1(800)605-8241**

[info@titandistributorsinc.com](mailto:info@titandistributorsinc.com)/[www.palletforks.com](http://www.palletforks.com)

**Business Hours: Monday–Friday • 8:00 a.m.–5:00 p.m. (CT)**

