



WWW.PALLETFORKS.COM
TITAN
ATTACHMENTS



OWNER'S MANUAL

MPN(s): FMJ3T

SKU(s): 194119

UPC(s): 737069522210

PARTS DIAGRAM / EXPLODED VIEW

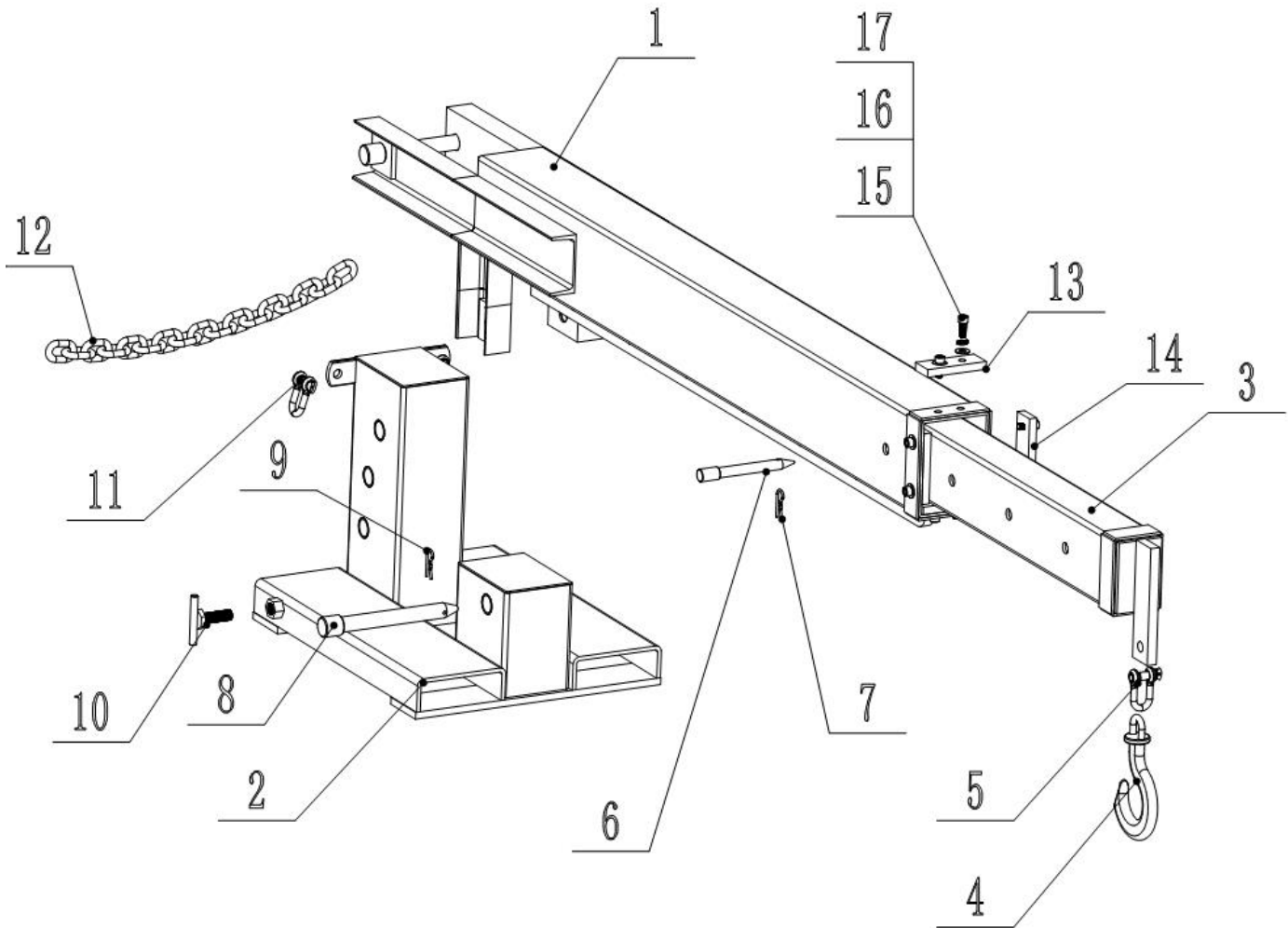

KEY	BOX	DESCRIPTION	QTY
(1)		Boom	1
(2)		Basement	1
(3)		Inner extension tube	1
(4)		Hook	2
(5)		Shackle	2
(6)		Rod	1
(7)		Pin	1
(8)		Rod	2
(9)		Pin	2



(10)		T screw	2
(11)		Shackle	2
(12)		Chain	1
(13)		Flat gasket	2
(14)		Flat gasket	2
(15)		Flat washer	8
(16)		Spring washer	8
(17)		Bolt	8

The Titan Adjustable Forklift Jib is installed on the forklift by inserting both forks fully into the fork pockets so that the rear of the Jib is against the back of the fork. If equipped with "Fork Pin Tabs", insert locking pins behind the heel of each fork and secure with hair pins. If equipped with a "safety chain", wrap chain around a strong part of the forklift carriage keeping chain as level as possible. Chain angle must not exceed 45°. Take as many wraps as needed to take up the slack, then hook the chain back onto itself making sure the open part of the grab hook is pointing down.

General Precautions

1. Forklift operator must be properly trained and have required certifications.
2. Before using the Jib check to see that it is properly secured to the forklift as described above and that the shackles and hooks are properly secured to the Jib and screw pins are tight.
3. Determine that the loads to be handled are within the capabilities of the forklift. Keep in mind that rated capacities will likely decrease when the boom is in a raised position, or when the mast is tilted forward, or in the case of telehandlers, when the boom is extended.
4. Forks should be level or tipped upward (never down below level) when using the jib.
5. Do not pull loads. Booms designed for vertical lift only.
6. The load should always be carried low and kept from swinging using tag lines as necessary. When a load is raised; extreme caution should be exercised as the forklift is far more vulnerable to tipping with a raised load.
7. Any time the load is raised make sure the forklift is on level, firm footing.
8. Check Jib boom extension lock pin to make sure it is functioning properly. Make sure spring has proper tension to keep pin engaged.
9. Refer to the forklift operator's manual for more information on handling elevated loads as well as information for safe and proper forklift operation.
10. Each time before use check all shackles and hooks, make sure cotter pins are installed properly. And shackle screw pins are tight.
11. Always comply with all local, state, and federal Safety regulations.
12. **DO NOT USE JIB IN ANY WAY TO CARRY OR ELEVATE PERSONNEL!**

<p>Fork Hook Capacity: 5500lbs</p>	<p> WARNING! READ AND FOLLOW THIS LABEL AND SUPPLIED INSTRUCTION SHEET BEFORE USING DO NOT USE TO LIFT PERSONNEL DO NOT LEAVE SUSPENDED LOAD UNATTENDED</p>
---	---



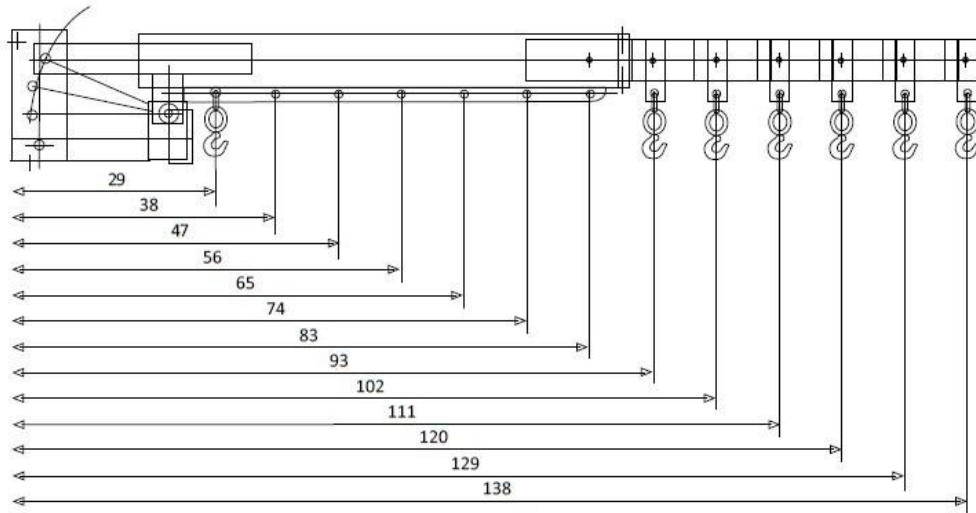

Length Positions (Inches)	29	38	47	56	65	74	83	93	102	111	120	129	138
Capacity (lbs)	6614	5051	4085	3430	2956	2597	2314	2081	1896	1742	1609	1497	1400

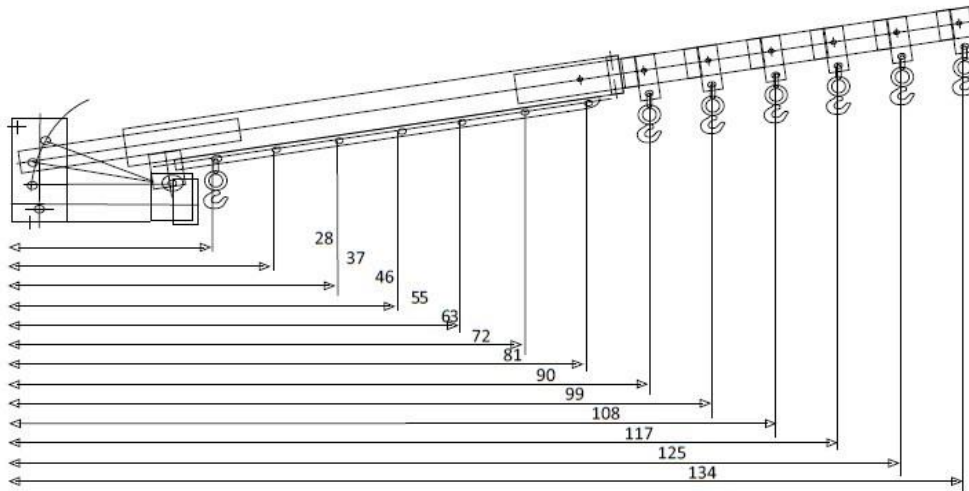

Length Positions (Inches)	28	37	46	55	63	72	81	90	99	108	117	125	134
Capacity (lbs)	6816	5196	4202	3522	3035	2665	2377	2136	1944	1788	1651	1537	1435

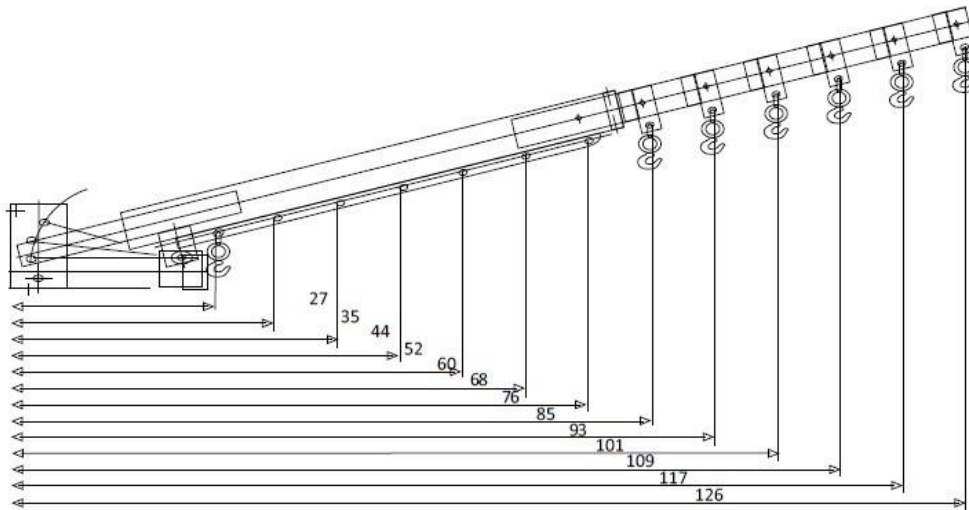

Length Positions (Inches)	27	35	44	52	60	68	76	85	93	101	109	117	126
Capacity (lbs)	7092	5456	4429	3730	3219	2833	2529	2275	2075	1907	1766	1642	1534



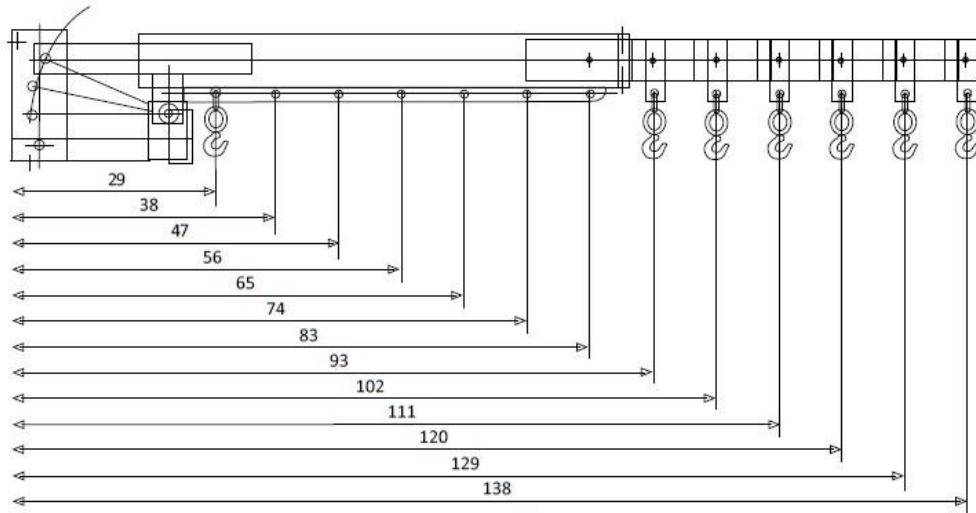

Length Positions (Inches)	29	38	47	56	65	74	83	93	102	111	120	129	138
Capacity (lbs)	6614	5051	4085	3430	2956	2597	2314	2081	1896	1742	1609	1497	1400

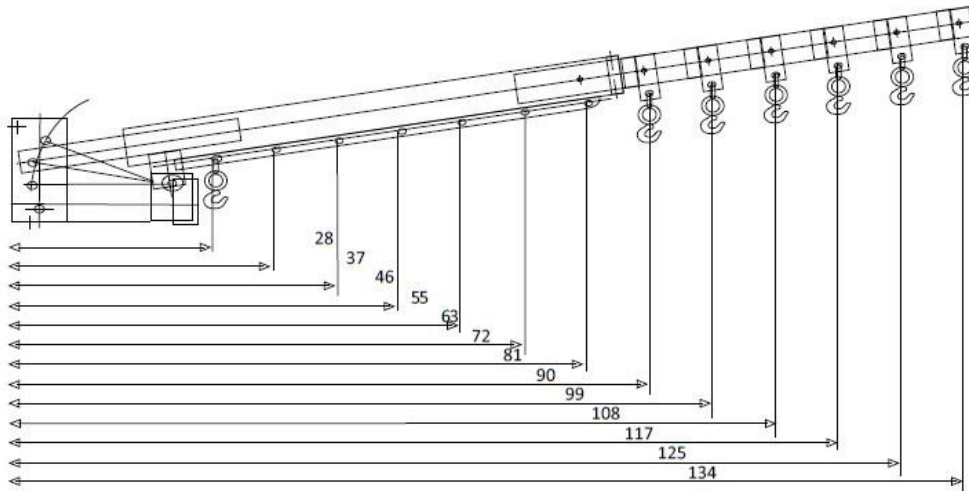

Length Positions (Inches)	28	37	46	55	63	72	81	90	99	108	117	125	134
Capacity (lbs)	6816	5196	4202	3522	3035	2665	2377	2136	1944	1788	1651	1537	1435

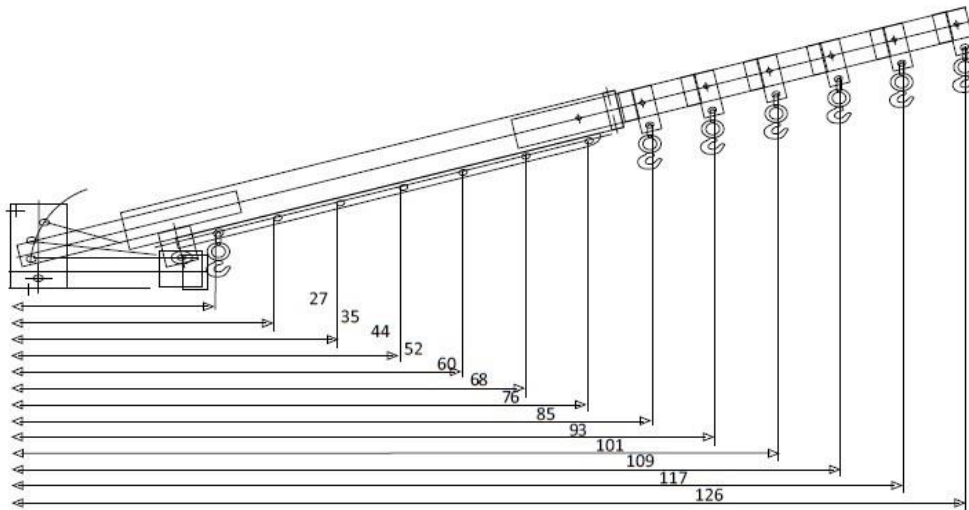

Length Positions (Inches)	27	35	44	52	60	68	76	85	93	101	109	117	126
Capacity (lbs)	7092	5456	4429	3730	3219	2833	2529	2275	2075	1907	1766	1642	1534





This concludes the FMJ3T Owner's Manual.

If applicable to your product, make sure to tighten all nut-and-bolt combinations before use.

Enjoy!

DISCLAIMER

This equipment must be used with care by capable and competent individuals under supervision, if necessary.

The use of any equipment, including this one, involves the potential risk of injury. You accept and assume full responsibility for any and all injuries, damages (both economic and non-economic), and losses of any type, which may occur, and you fully and forever release and discharge Titan, its insurers, employees, officers, directors, associates, and agents from any and all claims, demands, damages, rights of action, or causes of action, present or future, whether the same be known or unknown, anticipated, or unanticipated, resulting from or arising out of the use of said equipment.

TITAN MAKES NO WARRANTY WHATSOEVER WITH RESPECT TO THE EQUIPMENT, INCLUDING ANY WARRANTY OF MERCHANTABILITY OR WARRANTY OF FITNESS FOR A PARTICULAR PURPOSE, WHETHER EXPRESS OR IMPLIED BY LAW, COURSE OF DEALING, COURSE OF PERFORMANCE, USAGE OF TRADE OR OTHERWISE. BUYER ASSUMES ALL LIABILITY IN USE OF THE EQUIPMENT.

NEED HELP?

CONTACT US FIRST.

1(800)605-8241

info@titandistributorsinc.com/www.palletforks.com

Business Hours: Monday–Friday • 8:00 a.m.–5:00 p.m. (CT)

