

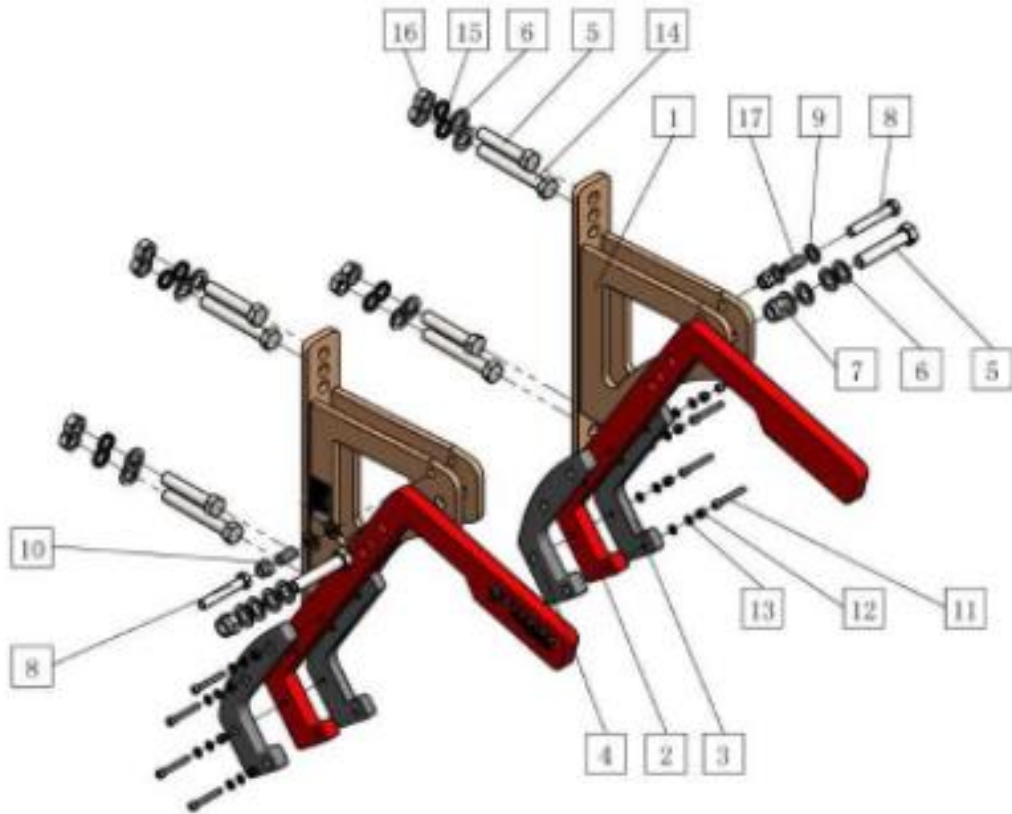

MPN: X2BLTMLIFT

Parts Diagram



PARTS & HARDWARE LIST		
KEY #	DESCRIPTION	QTY
(1)	MAIN BRACKET	x2
(2)	SWING ARM	x2
(3)	UHMW HOOK PAD – LEFT	x2
(4)	UHMW HOOK PAD – RIGHT	x2
(5)	M16x80 HEX BOLT	x2
(6)	16 FLAT WASHER	x16
(7)	M16 HEX NYLON LOCK NUT	x2
(8)	M12x70 HEX BOLT	x2
(9)	12 FLAT WASHER	x4
(10)	M12 HEX NYLON LOCK NUT	x2
(11)	M6x45 COUNTERSUNK HEX BOLT	x8
(12)	M6 HEX NYLON LOCK NUT	x8
(13)	6 FLAT WASHER	x16
(14)	M16x110 HEX BOLT	x4
(15)	16 SPRING WASHER	x8
(16)	M16 HEX NUT	x8
(17)	PLASTIC BOLT SLEEVE	x2

NEED HELP?

CONTACT US FIRST.

1 (800) 605-8241

info@titandistributorsinc.com / www.titan.fitness

Business Hours: Monday–Friday • 8:00 a.m.–5:00 p.m. (CT)