

POTATO DIGGER

POTATODIG

191379



Operator's Manual

Read the Operator's Manual entirely. When you see this symbol, the subsequent instructions and warnings are serious follow without exception. Your life and the lives of others depend on it!

PARTS DIAGRAM / EXPLODED VIEW

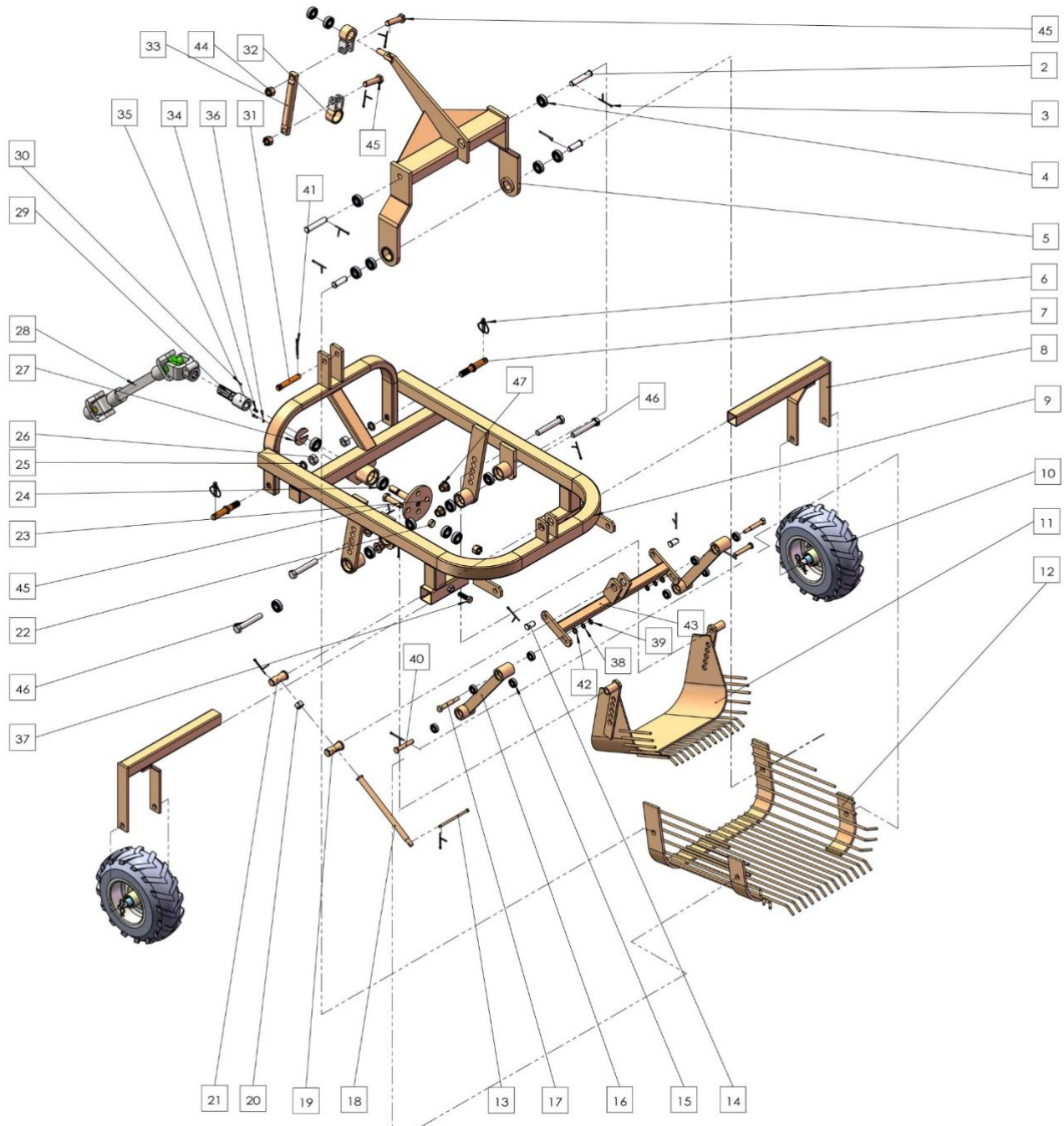

KEY	DESCRIPTION	QTY	KEY	DESCRIPTION	QTY
(1)	PIN SHAFT A20X60	2	(25)	SPRING WASHER M22	2
(2)	PIN SHAFT A20X100	2	(26)	HEX NUT M22	2
(3)	COTTER PIN 5X63	15	(27)	CLAMP DISC	1
(4)	BALL BEARING 6204	16	(28)	PTO UNIVERSAL ARM	1
(5)	FRONT PIVOT LIFT FRAME ASSY	1	(29)	PTO STEERING CLAMP	1
(6)	LOCK PIN ϕ 9.5	2	(30)	COUNTERSUNK HEX STUD BOLT M6X6	1
(7)	CAT1 LOWER PIN	2	(31)	CAT1 UPPER PIN	1
(8)	TIRE/WHEEL FRAME	2	(32)	BALL BEARING SEAT	2
(9)	MIAN FRAME	1	(33)	FRONT PIVOT LIFT ARM	1
(10)	TIRE/WHEEL ASSY	2	(34)	FLAT KEY 6x6x22	1
(11)	DIGGER BUCKET	1	(35)	COUNTERSUNK COLUMN HEAD HEX BOLT M6X16	1
(12)	SIFT BASKET	1	(36)	SPRING WASHER M6	1
(13)	HANDLE TURN SHAFT	1	(37)	HEX BOLT M16x50	2
(14)	PIN SHAFT A20X35	2	(38)	SPRING WASHER M12	2
(15)	BALL BEARING 6202	8	(39)	HEX THIN NUT M12	2
(16)	SIFT BASKET HINGED ARM	2	(40)	SIFT BASKET HINGED ARM PIN-2	2
(17)	SIFT BASKET HINGED ARM PIN-1	2	(41)	COTTER PIN 4x70	1
(18)	HEIGHT ADJUSTMENT BOLT SHAFT	1	(42)	FLAT WASHER M12	2
(19)	REAR PIVOT LIFT FRAME PIN	1	(43)	REAR PIVOT FRAME	1
(20)	HEX NUT M20	1	(44)	SLOTTED HEX NUT M20	3
(21)	HEIGHT ADJUSTMENT BOLT SHAFT PIN-1	1	(45)	BALL BEARING SEAT PIN	3
(22)	PIN BUSHING	1	(46)	HEX BOLT M20x120	4
(23)	OFFSET DISC	1	(47)	HEX LOCK NUT M20	4
(24)	BALL BEARING 6205	2			

WHEEL ASSEMBLY PARTS DIAGRAM / EXPLODED VIEW ASSEMBLY INSTRUCTIONS

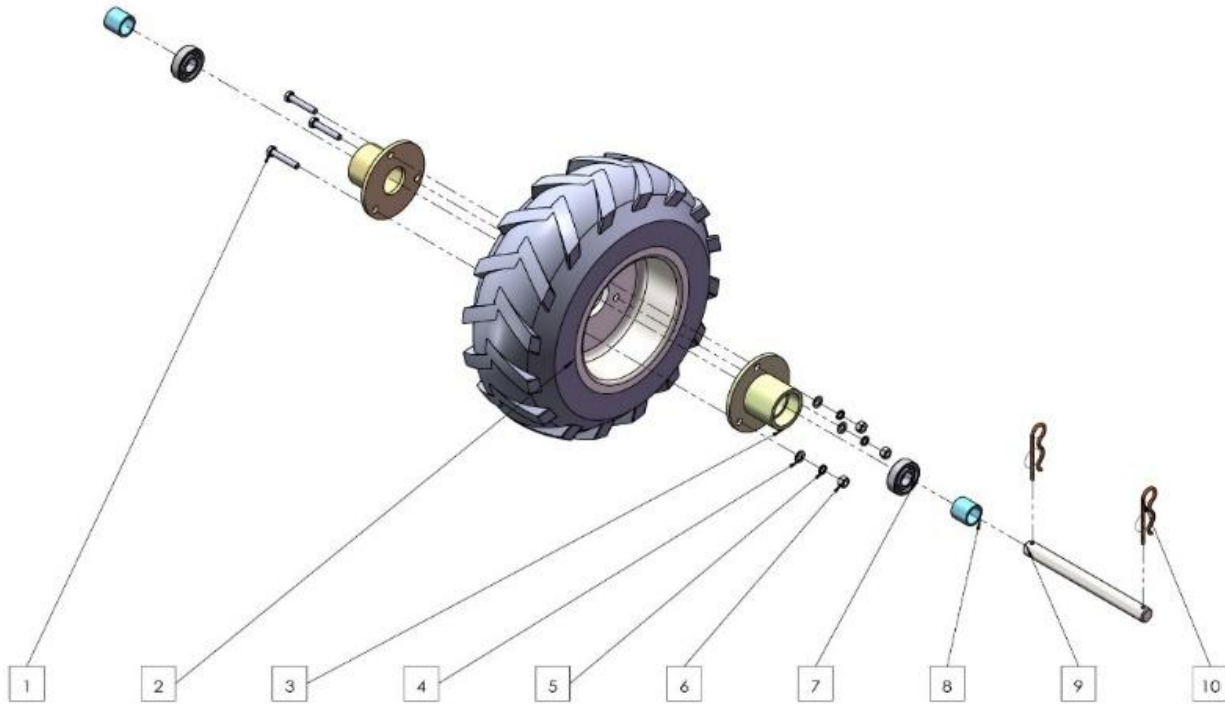

KEY	DESCRIPTION	QTY	KEY	DESCRIPTION	QTY
(1)	HEX BOLT M8X45	3	(6)	HEX NUT M8	3
(2)	TIRE/WHEEL	1	(7)	BALL BEARING 6204	2
(3)	BEARING HOUSING	2	(8)	SHAFT BUSHING (POTATODIG-18)	1
(4)	FLAT WASHER M8	3	(9)	SHAFT (POTATODIG-	1
(5)	SPRING WASHER M8	3	(10)	COTTER PIN 4X70	2

ASSEMBLY INSTRUCTIONS

- This product is shipped fully assembled.

ACKNOWLEDGEMENT OF RISK AND RELEASE OF LIABILITY

The use of any equipment, including this one, involves the potential risk of injury. Apart from any warranty claim that might be presented for a claimed defect in material or workmanship of the product, you accept and assume full responsibility for any and all injuries, damages (both economic and non-economic), and losses of any type, which may occur, and you fully and forever release and discharge Titan, its insurers, employees, officers, directors, associates, and agents from any and all claims, demands, damages, rights of action, or causes of action, present or future, whether the same be known or unknown, anticipated, or unanticipated, resulting from or arising out of the use of said equipment.

This equipment must be used with care by capable and competent individuals under supervision, if necessary.

WARNING



Do not overfill! Mower should be level when checking oil in gear box.



some activities might be able to cause electric shock



Sharp objects may be involved.
Use protective cover during maintenance.

TITAN LIMITED WARRANTY: TERMS, EXCLUSIONS AND LIMITATIONS OF REMEDIES

This product comes with a one (1) year limited warranty that can be found at www.palletforks.com/warranty.html. Please review the same for all details regarding the Titan Limited Warranty.

THE TITAN LIMITED WARRANTY FOUND AT WWW.PALLETFORKS.COM/WARRANTY.HTML IS EXCLUSIVE AND IS IN LIEU OF ALL OTHER WARRANTIES, EXPRESS OR IMPLIED, INCLUDING ANY IMPLIED WARRANTY OF MERCHANTABILITY AND/OR FITNESS FOR A PARTICULAR PURPOSE, EACH OF WHICH IS HEREBY DISCLAIMED.



NEED HELP? CONTACT US FIRST.

1-800-605-7595

info@palletworks.com

www.palletforks.com

© 2021 Titan Brands