

KETTLE GRILL TABLE

KTLGRLTBL
899290



Operator's Manual



Read the Operator's Manual entirely. When you see this symbol, the subsequent instructions and warnings are serious follow without exception. Your life and the lives of others depend on it!

TITAN
GREAT OUTDOORS

PARTS DIAGRAM / EXPLODED VIEW

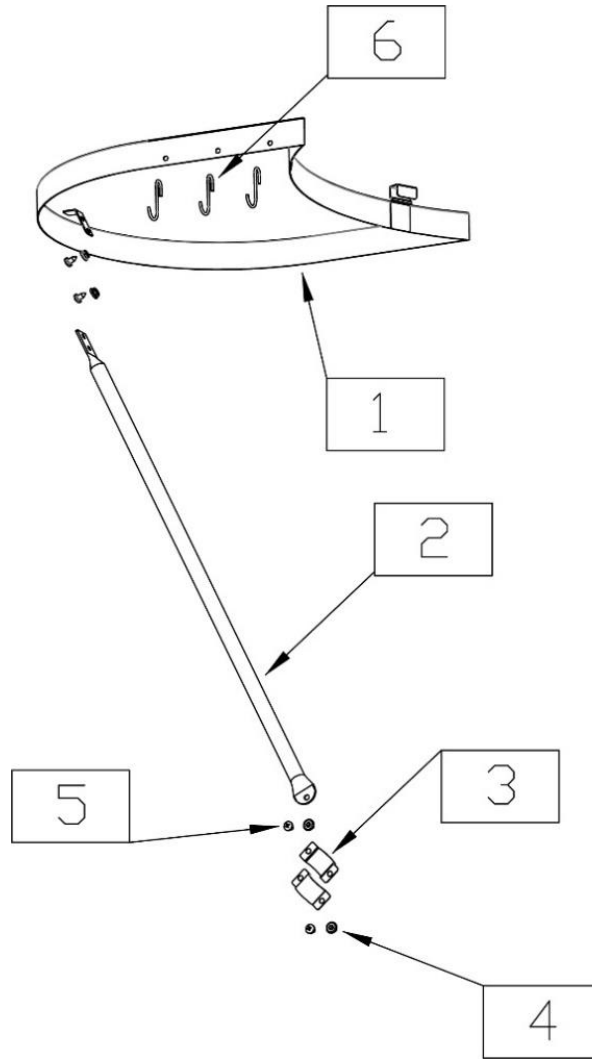

Phillips screwdriver and pliers is needed, not included.

KEY	BOX	DESCRIPTION	QTY
(1)	1	TABLE	1
(2)	1	SUPPORTING POLE	1
(3)	1	TUBE CLAMP	2
(4)	1	NUT (M5)	4
(5)	1	SCREW (M5 X 10)	4
(6)	1	HOOK	3

ASSEMBLY INSTRUCTIONS

STEP 1: The **SUPPORTING POLE (2)** has one hole on one end, and the other end has two holes; assemble the **TUBE CLAMP (3)** on the **SUPPORTING POLE**, which has only one hole by using one **SCREW (5)** and one **NUT (4)**.

NOTE: Both Tabs of the clamp must be on the same side of the tube.

DO NOT FASTEN THE SCREW/NUT.

STEP 2: Assemble the other end of the **SUPPORTING POLE** on the back of the **TABLE (1)** by using two **SCREW (5)** and two **NUT (4)**.

STEP 3: Remove the lid of your kettle, place **TABLE (1)** on your kettle by snapping the two clips onto the edge of your kettle.

STEP 4: Assemble **TUBE CLAMP (3)** on either back leg above the wheel of your kettle. Put one **SCREW (5)** and one **NUT (4)** on the other hole of the **TUBE CLAMP**, make sure the **TABLE** is even and horizontal, then fasten both **SCREWS** and **NUTS** on the **TUBE CLAMP**.

NOTE: Both Tabs of the clamp must be on the same side of the tube.

STEP 5:

Place the three-piece **HOOKS (6)** in pre-drilled mounting holes.

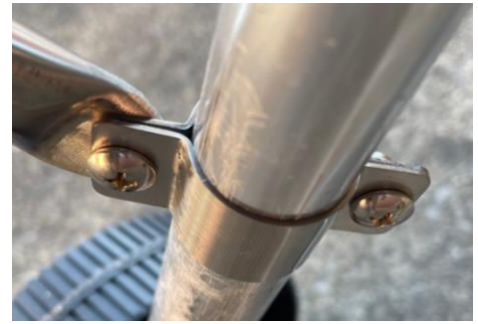

ACKNOWLEDGEMENT OF RISK AND RELEASE OF LIABILITY

The use of any equipment, including this one, involves the potential risk of injury. Apart from any warranty claim that might be presented for a claimed defect in material or workmanship of the product, you accept and assume full responsibility for any and all injuries, damages (both economic and non-economic), and losses of any type, which may occur, and you fully and forever release and discharge Titan, its insurers, employees, officers, directors, associates, and agents from any and all claims, demands, damages, rights of action, or causes of action, present or future, whether the same be known or unknown, anticipated, or unanticipated, resulting from or arising out of the use of said equipment.

This equipment must be used with care by capable and competent individuals under supervision, if necessary.

WARNING



Choking hazard. Small parts – Please exercise caution if small children or pets are present.



Sharp objects may be involved. Use precaution and protection.

TITAN LIMITED WARRANTY: TERMS, EXCLUSIONS AND LIMITATIONS OF REMEDIES

This product comes with a one (1) year limited warranty that can be found at www.titangreatoutdoors.com/warranty.html. Please review the same for all details regarding the Titan Limited Warranty.

THE TITAN LIMITED WARRANTY FOUND AT WWW.TITANGREATOUTDOORS.COM/WARRANTY.HTML IS EXCLUSIVE AND IS IN LIEU OF ALL OTHER WARRANTIES, EXPRESS OR IMPLIED, INCLUDING ANY IMPLIED WARRANTY OF MERCHANTABILITY AND/OR FITNESS FOR A PARTICULAR PURPOSE, EACH OF WHICH IS HEREBY DISCLAIMED.



NEED HELP? CONTACT US FIRST.

1-888-794-1455

info@titangreatoutdoors.com
www.titangreatoutdoors.com

© 2021 Titan Brands