

DUO STAINLESS STEEL FIRE PIT WITH LID

SSFP_SM, SSFP_MD, SSFP_LG

899291, 899292, 899293



Operator's Manual

TITAN
GREAT OUTDOORS



Read the Operator's Manual entirely. When you see this symbol, the subsequent instructions and warnings are serious follow without exception. Your life and the lives of others depend on it!

PARTS DIAGRAM / EXPLODED VIEW

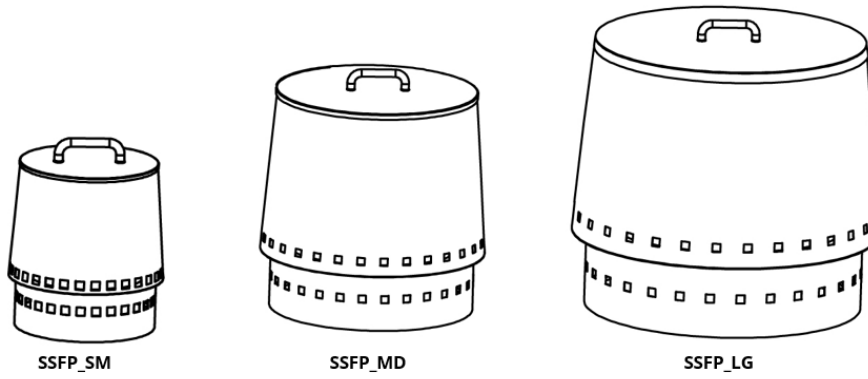

AVAILABLE IN SMALL, MEDIUM, OR LARGE SIZES

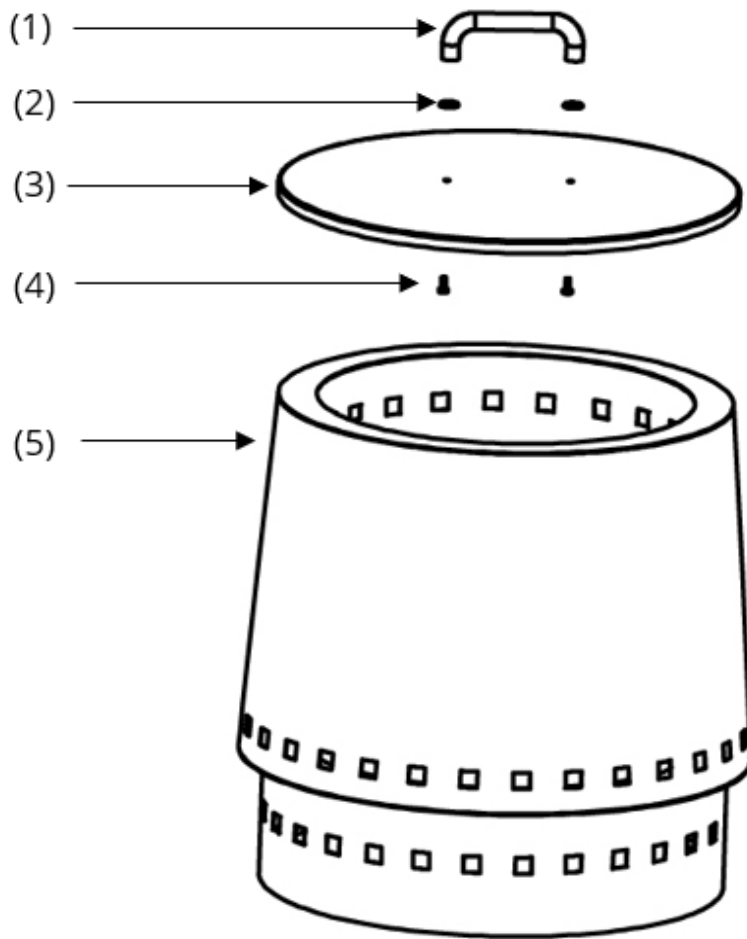

KEY	DESCRIPTION	QTY	KEY	DESCRIPTION	QTY
(1)	HANDLE	1	(4)	SCREW	2
(2)	WASHER	2	(5)	FIREPIT BODY	1
(3)	LID	1			

HOW TO USE

Step 1:

The handle is pre-assembled on the backside of the lid, unscrew it and re-install the handle on the outer side of the cover.

Step 2:

Remove all plastic on the stainless steel, place the fire pit on an even non-combustible surface.

Step 3.

Stack the wood logs and kindling inside the fire pit. Do not overfill the fire pit with wood higher than the top of the interior air vents. For best results, the recommended log sizes for the fire pit sizes are:

- DUO Small - 10-12-inch-long firewood
- DUO Medium - 14-16-inch-long firewood
- DUO Large - 16-18-inch-long firewood

Step 4:

Light the kindling, and it will quickly become a roaring fire much quicker than a conventional fire pit.

Step 5:

Carefully add additional logs to keep the fire burning when needed.

Step 6:

when you are done with the fire, let the wood logs burn out. You may let the wood burn out with the lid on or off; Either way the wood will burn out completely, leaving very little ash. Leave the fire pit to get cool completely.

Step 7:

Once cool, turn the fire pit entirely over to empty the ashes from the interior and the bottom air holes.

Step 8:

Store the firepit in a cool, dry place; keep away from children and pets.

It is considered normal that the stainless-steel color may be yellow over time due to extremely high temperatures; this will not affect regular use.

WARNINGS

- ⚠ For outdoor use only.
- ⚠ Never touch the metal surface of a fire pit with an active burn with bare hands.
- ⚠ Keep distance from combustible material.
- ⚠ Keep away from children and pets when in use.
- ⚠ Use dry wood logs only. Do not use gasoline, kerosene, diesel fuel, lighter fluid, alcohol, or any other flammable liquid.
- ⚠ Do not use water to extinguish the fire; this will damage the firepit and injure the user.
- ⚠ Serious injury or even death and/or property damage may occur if instructions are not followed exactly.

ACKNOWLEDGEMENT OF RISK AND RELEASE OF LIABILITY

The use of any equipment, including this one, involves the potential risk of injury. Apart from any warranty claim that might be presented for a claimed defect in material or workmanship of the product, you accept and assume full responsibility for any and all injuries, damages (both economic and non-economic), and losses of any type, which may occur, and you fully and forever release and discharge Titan, its insurers, employees, officers, directors, associates, and agents from any and all claims, demands, damages, rights of action, or causes of action, present or future, whether the same be known or unknown, anticipated, or unanticipated, resulting from or arising out of the use of said equipment.

This equipment must be used with care by capable and competent individuals under supervision, if necessary.

WARNING



Heavy object. Use lifting aids and proper lifting techniques when moving.



Choking hazard. Small parts - Please exercise caution if small children or pets are present.



Sharp objects may be involved. Use precaution and protection.

TITAN LIMITED WARRANTY: TERMS, EXCLUSIONS AND LIMITATIONS OF REMEDIES

This product comes with a one (1) year limited warranty that can be found at www.titangreatoutdoors.com/warranty.html. Please review the same for all details regarding the Titan Limited Warranty.

THE TITAN LIMITED WARRANTY FOUND AT WWW.TITANGREATOUTDOORS.COM/WARRANTY.HTML IS EXCLUSIVE AND IS IN LIEU OF ALL OTHER WARRANTIES, EXPRESS OR IMPLIED, INCLUDING ANY IMPLIED WARRANTY OF MERCHANTABILITY AND/OR FITNESS FOR A PARTICULAR PURPOSE, EACH OF WHICH IS HEREBY DISCLAIMED.



NEED HELP? CONTACT US FIRST.

1-888-794-1455

info@titangreatoutdoors.com
www.titangreatoutdoors.com

© 2021 Titan Brands