

# 10' HD SKID STEER RAMPS

---

10SSRAMPHD, (2)10SSRAMPHD

310105, 310106



**TITAN**  
RAMPS

## Operator's Manual



Read the Operator's Manual entirely. When you see this symbol, the subsequent instructions and warnings are serious follow without exception. Your life and the lives of others depend on it!

**PARTS DIAGRAM / EXPLODED VIEW**

---



| KEY | BOX | DESCRIPTION         | QTY |
|-----|-----|---------------------|-----|
| (1) | 1   | RAMP                | 1   |
| (2) | 1   | CHANNEL GUIDE PLATE | 1   |
| (3) | 1   | LOCKING PIN         | 1   |

The quantities above represent the 10SSRAMPHD. Double the quantities if you have (10)6SSRAMPHD.

**SAFETY WARNING:**

The Maximum Loading Height is 35 in. Do not exceed maximum loading height. The Weight Capacity of Ramp is 10,000 LB – PAIR.

## ASSEMBLY INSTRUCTIONS

---

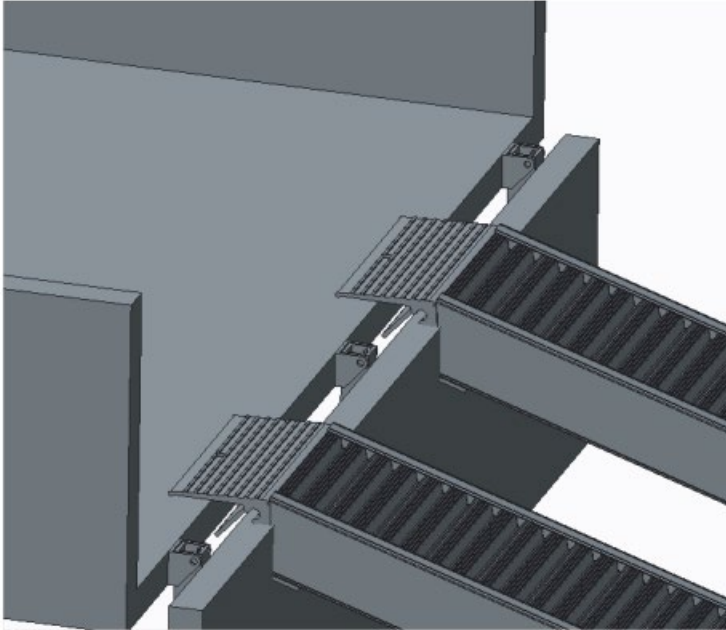

This ramp comes with a removable channel guide plate and a locking pin for trailers.

Here are the instructions.

- 1) Park vehicle or trailer on flat and firm ground.
- 2) Place ramps on the tailgate or trailer to accommodate the wheelbase of the loading vehicle.
- 3) Ensure the plate or fingers of the ramp are securely in place. You can fix the ramp with channel guide plate or the locking pin, depending on the situation.

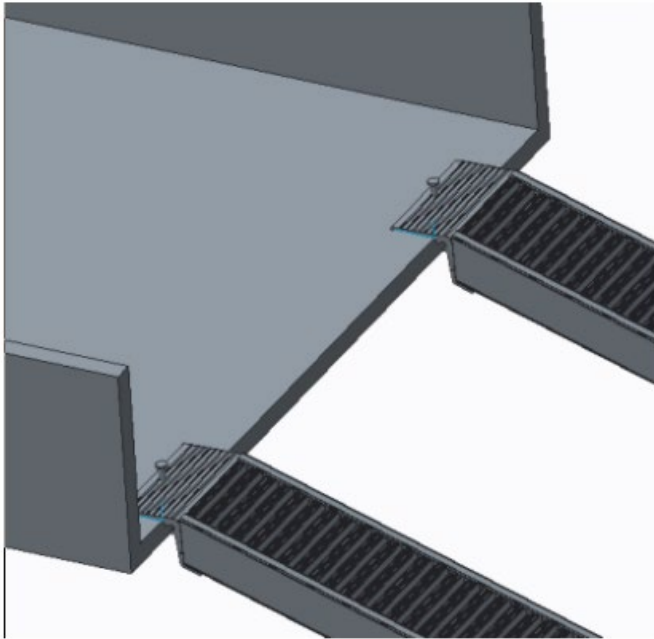

## **ACKNOWLEDGEMENT OF RISK AND RELEASE OF LIABILITY**

---

The use of any equipment, including this one, involves the potential risk of injury. Apart from any warranty claim that might be presented for a claimed defect in material or workmanship of the product, you accept and assume full responsibility for any and all injuries, damages (both economic and non-economic), and losses of any type, which may occur, and you fully and forever release and discharge Titan, its insurers, employees, officers, directors, associates, and agents from any and all claims, demands, damages, rights of action, or causes of action, present or future, whether the same be known or unknown, anticipated, or unanticipated, resulting from or arising out of the use of said equipment.

This equipment must be used with care by capable and competent individuals under supervision, if necessary.

## **TITAN LIMITED WARRANTY: TERMS, EXCLUSIONS AND LIMITATIONS OF REMEDIES**

---

This product comes with a one (1) year limited warranty that can be found at [www.titanramps.com/warranty.html](http://www.titanramps.com/warranty.html). Please review the same for all details regarding the Titan Limited Warranty.

**THE TITAN LIMITED WARRANTY FOUND AT [WWW.TITANRAMPS.COM/WARRANTY.HTML](http://WWW.TITANRAMPS.COM/WARRANTY.HTML) IS EXCLUSIVE AND IS IN LIEU OF ALL OTHER WARRANTIES, EXPRESS OR IMPLIED, INCLUDING ANY IMPLIED WARRANTY OF MERCHANTABILITY AND/OR FITNESS FOR A PARTICULAR PURPOSE, EACH OF WHICH IS HEREBY DISCLAIMED.**



**NEED HELP? CONTACT US FIRST.**

**1-800-605-7555**

[info@titanramps.com](mailto:info@titanramps.com)

[www.titanramps.com](http://www.titanramps.com)

© 2021 Titan Brands