

# LARGE OFF-ROAD SPARE TIRE HOLDER

---

TRHLDR  
350105



## Operator's Manual



Read the Operator's Manual entirely. When you see this symbol, the subsequent instructions and warnings are serious follow without exception. Your life and the lives of others depend on it!

PARTS DIAGRAM / EXPLODED VIEW

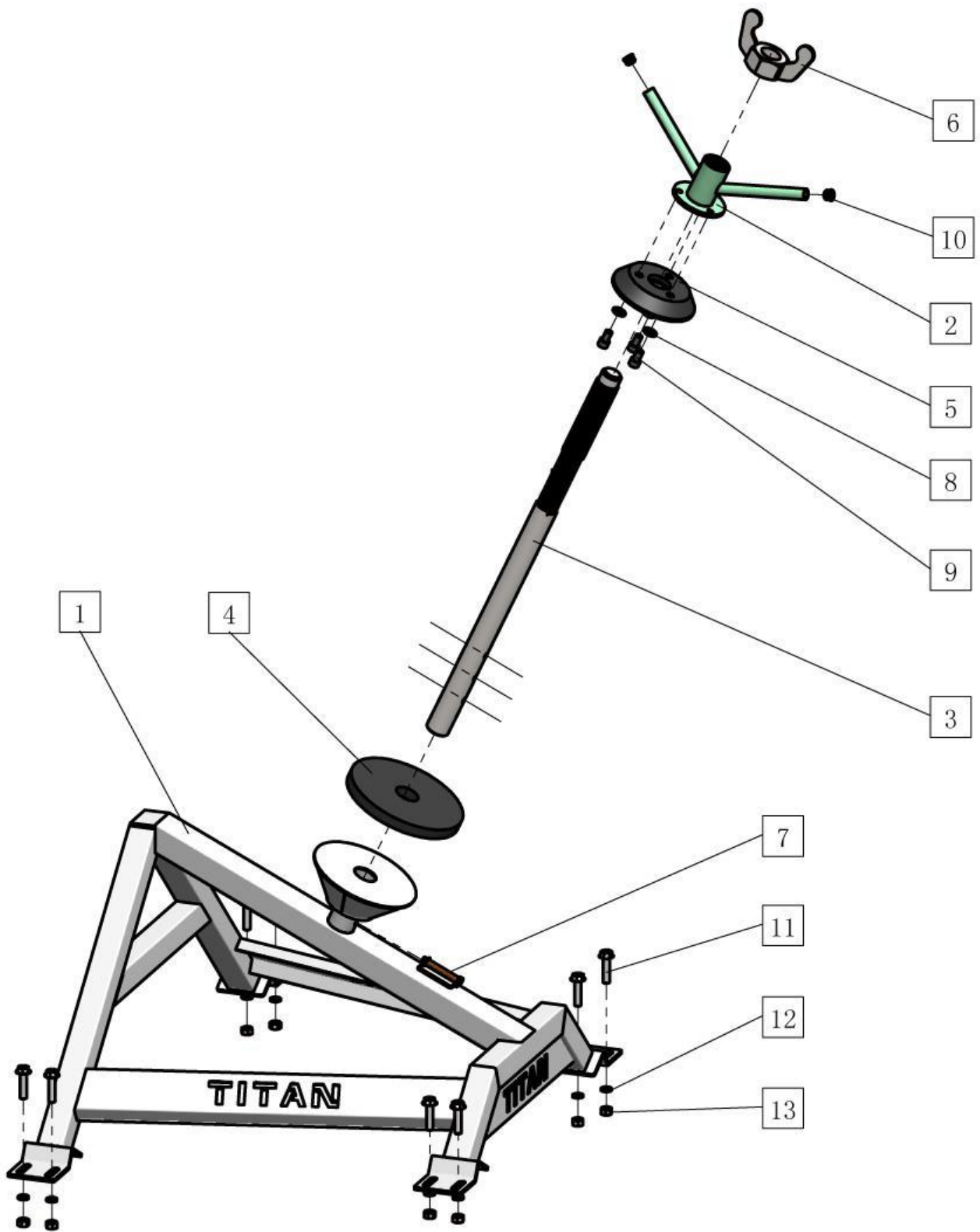

KEY	BOX	DESCRIPTION	QTY
(1)	1	TIRE STORAGE STAND	1
(2)	1	LOCK HANDLE	1
(3)	1	TIRE INSERT SHAFT	1
(4)	1	LOWER RUBBER CUSHION	1
(5)	1	UPPER RUBBER BOWL	1
(6)	1	BUTTERFLY NUT	1
(7)	1	SAFETY PIN	1
(8)	1	FLAT WASHER 12	3
(9)	1	COUNTERSUNK HEXA BOLT M12X20	3
(10)	1	TUBE END CAP	2
(11)	1	FLANGED HEX BOLT M12X50	8
(12)	1	SPRING WASHER 12	8
(13)	1	HEX NUT M12	8

## ASSEMBLY INSTRUCTIONS

---

### STEP 1 – BOLT TIRE STORAGE STAND ON TRUCK BED

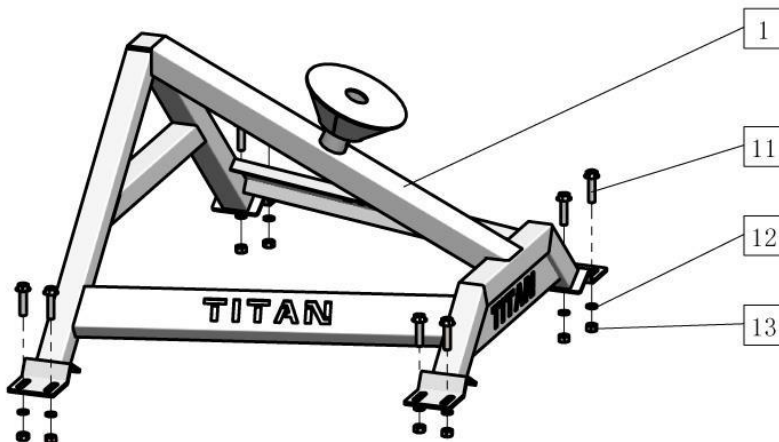

Bolt Tire Storage Stand (1) on flooring of truck bed using Flanged Hex Bolt M12x50 (11), Spring Washer 12 (12) and Hex Nut M12 (13). The order of assembling is to push Flanged Hex Bolt M12x50 (11) through this part, and then place Spring Washer 12 (12) and Hex Nut M12 (13) onto the end of the bolt. Tighten all hardware.

## STEP 2 – ASSEMBLING THE TIRE INSERT SHAFT

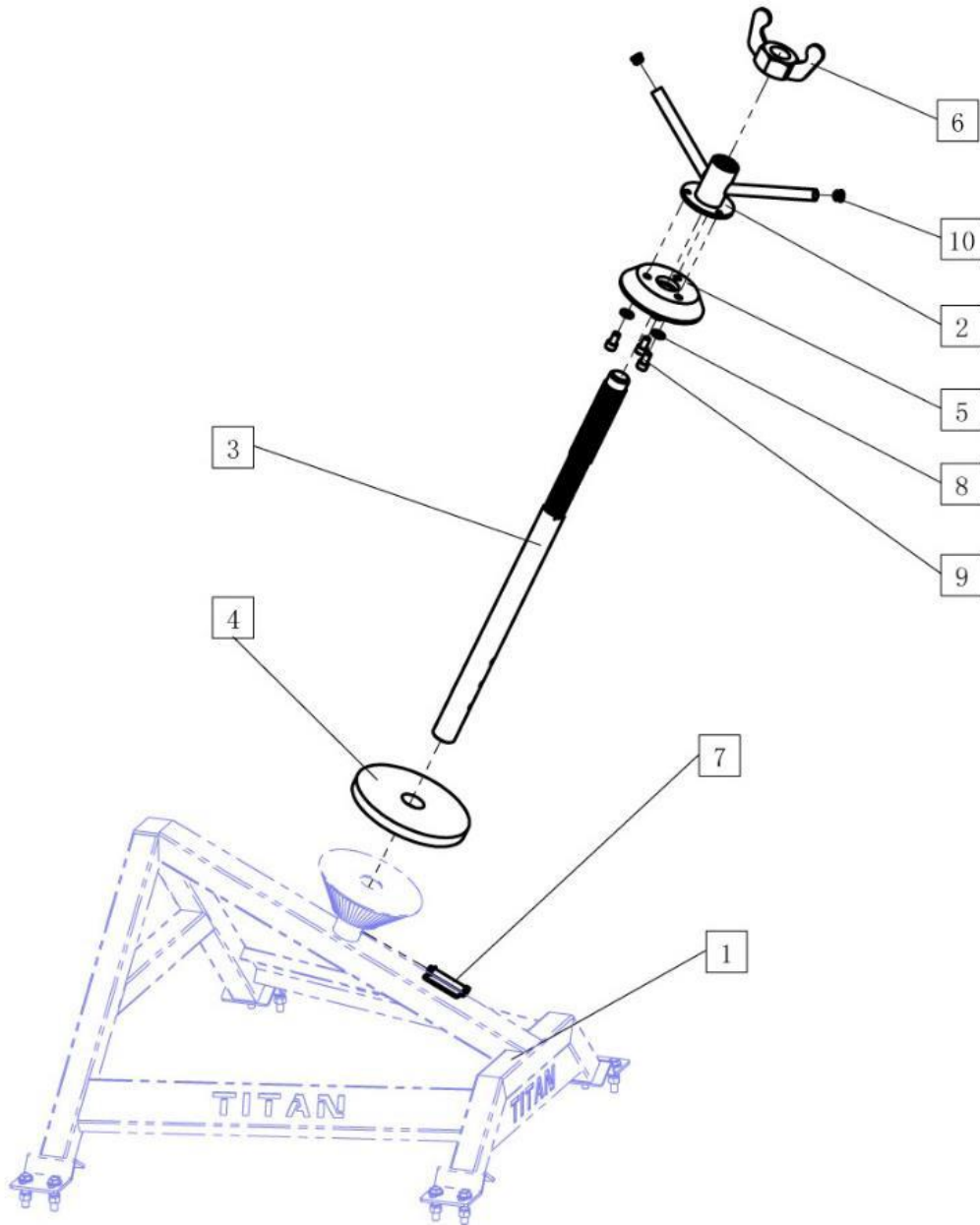

1. Push the Tire Insert Shaft (3) through Lower Rubber Cushion and the bowl of Tire Storage Stand (1).
2. Fasten the Tire Insert Shaft (3) on Tire Storage Stand (1) using Safety Pin (7).
3. Fasten Upper Rubber Bowl (5) on Lock Handle (2) using Flat Washer 12 (8) and Countersunk Hex bolt (9).
4. Tighten all hardware.
5. Insert Tube End Cap (10) into the tube of Lock Handle (2).
6. When storing tire, insert the tire into Tire Insert Shaft (3), and then tighten the tire with the Lock Handle (2)
7. by turning it down the threading of the Tire Insert Shaft (3). For additional safety, turn the Butterfly Nut
8. down the threading of Tire Insert Shaft (3) to lock all parts in place.

## ACKNOWLEDGEMENT OF RISK AND RELEASE OF LIABILITY

---

The use of any equipment, including this one, involves the potential risk of injury. Apart from any warranty claim that might be presented for a claimed defect in material or workmanship of the product, you accept and assume full responsibility for any and all injuries, damages (both economic and non-economic), and losses of any type, which may occur, and you fully and forever release and discharge Titan, its insurers, employees, officers, directors, associates, and agents from any and all claims, demands, damages, rights of action, or causes of action, present or future, whether the same be known or unknown, anticipated, or unanticipated, resulting from or arising out of the use of said equipment.

This equipment must be used with care by capable and competent individuals under supervision, if necessary.

## WARNING

---



Heavy object. Use lifting aids and proper lifting techniques when moving.



Choking hazard. Small parts – Please exercise caution if small children or pets are present.



Sharp objects may be involved. Use precaution and protection.

## TITAN LIMITED WARRANTY: TERMS, EXCLUSIONS AND LIMITATIONS OF REMEDIES

---

This product comes with a one (1) year limited warranty that can be found at [www.titanramps.com/warranty.html](http://www.titanramps.com/warranty.html). Please review the same for all details regarding the Titan Limited Warranty.

**THE TITAN LIMITED WARRANTY FOUND AT [WWW.TITANRAMPS.COM/WARRANTY.HTML](http://WWW.TITANRAMPS.COM/WARRANTY.HTML) IS EXCLUSIVE AND IS IN LIEU OF ALL OTHER WARRANTIES, EXPRESS OR IMPLIED, INCLUDING ANY IMPLIED WARRANTY OF MERCHANTABILITY AND/OR FITNESS FOR A PARTICULAR PURPOSE, EACH OF WHICH IS HEREBY DISCLAIMED.**



**NEED HELP? CONTACT US FIRST.**

**1-800-605-7555**

[info@titanramps.com](mailto:info@titanramps.com)

[www.titanramps.com](http://www.titanramps.com)

© 2021 Titan Brands