

TRANSPLANTER TREE SPADE

35TRANSPLANTR

191504



Operator's Manual



Read the Operator's Manual entirely. When you see this symbol, the subsequent instructions and warnings are serious follow without exception. Your life and the lives of others depend on it!



- Please read the product manual completely before assembly
- Check against the parts list to make sure all parts are received
- Wear proper safety goggles or other protective gears while in assembly

**TO OPERATE THIS IMPLEMENT,
USER MUST FIRST CONNECT TO EXTERNAL 12V POWER SOURCE.**

SAFETY INSTRUCTIONS

Please read the following instructions before installing or operating.

ONLY QUALIFIED PERSONAL MAY OPERATE EQUIPMENT

- Complete regular maintenance of your machine.
- New and existing parts will need properly maintained safety signs.
- Never operate machine unless properly instructed on maintenance and use.
- Do not operate machine if under the influence of drugs, alcohol, fatigue or feeling ill.
- This manual does not replace any laws or regulations. If you are unsure of any laws or regulations concerning your machine, please visit: www.asae.org or www.osha.gov.

MAKE SURE TO CHECK ALL HYDRAULIC LINES BEFORE OPERATION

- High pressure Hydraulic lines can cause injury or death if not properly maintained.
- Hydraulic hose can fail due to age, damage, or exposure.
- When checking for leaks make sure to wear proper PPE.
- Use cardboard or other material to check for leaks, never use hands.
- If injured by hydraulic fluid immediately seek medical attention.
- Before Operation of The Machine Perform Basic Movement Test
- Make sure that each blade can travel the full distance.
- Make sure all blades open and close properly.

DO NOT MODIFY MACHINE

- Altering machine may cause unsafe operations.
- Altering machine may void operator's warranty.
- Altering machine may cause severe injury or death.

FOR TREE REMOVAL AND TRANSPORT ONLY

- Never transport or lift passengers in machine.
- Do Not work of the machine.

SLOW OPERATIONAL SPEED

- When moving machine from one location to the next, Keep away from uneven terrain.
- Move at a slow and consistent speed.

ELEVATED MACHINE

- Never approach machine when in raised position.
- Always round machine, engage all breaks, remove keys, before embarking on maintenance of machine.
- Failure to follow guideline above may result in server injury or death.

PREVENTING ROLLOVERS

- Move at slow speeds during travel.
- Avoid sudden movements especially when on uneven terrain.
- Do not overload machines weight capacity.
- When traveling avoid all obstructions.
- Never work on overly steep terrain.

SAFE REMOVAL OF MACHINE

- Remove machine on hard and even terrain.
- Failure to do so may cause machine to fall over.

PROPER MAINTENANCE PROCEDURES

- Park machine on level terrain, check to see if all breaks are set, check that all moveable objects are locked in place, Place "serving" tag on machine before embarking on maintenance.
- If unsure on how to perform proper Maintenance, please consult user manual.
- Always wear proper PPE.
- Always use Titan attachments certified parts in the event of replacement of component.

AVOIDING UTILITIES

- Always check overhead clearance before elevating machine.
- Make sure that all utilities are marked, and all operators are aware before digging.
- In the event of a pierced or contacted utility remain in place.

PRODUCT INSTRUCTIONS

1	Shovel Blade 1
2	Tube 1
3	Cylinder 1 (inside tube)
4	Footstep
5	Shovel Blade 3
6	Tube 3
7	Cylinder 3 (inside tube)
8	Tube 2
9	Cylinder 2 (inside tube)
10	Shovel Blade 2
11	Gate
12	Hinge Pin
13	Outrigger
14	controller

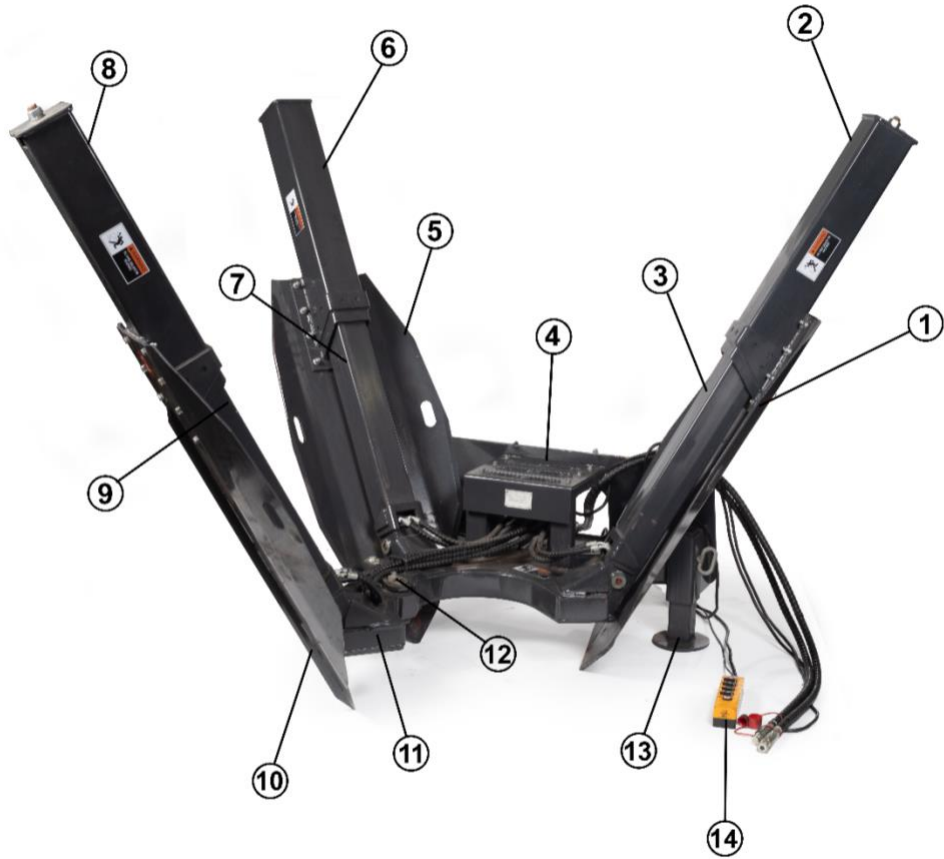

SPECIFICATIONS			
OVERALL LENGTH	71.9 IN (1828 MM)	CUTTING BLADE ANGLE	30 DEGREES
OVERALL WIDTH	70 IN (1780 MM)	WORKING FLOW	5.2-17.7 GPM (20-65 LPM)
OVERALL HEIGHT	71.4 IN (1815 MM)	WORKING PRESSURE	1,740- 3,045 PSI (12-21 MPA)
TOTAL WEIGHT	1,499LB (680 KG)	TREE TRUNK DIA.	0-3.9 IN (0-100 MM)
DIGGING DEPTH	29.4 IN (747 MM)	TREE BALL DIA.	0-34.6 IN (0-880 MM)

OPERATION INSTRUCTIONS

MACHINE CONTROLS

1. **The transplanter is manufactured standard with exposed wiring for power source connection. Owner/operator will need to wire this to a 12V power source for proper function of the provided controller.**
2. Fully retract/contract Shovel Blade 1, Shovel Blade 2, and Shovel Blade 3, by turning each switch.
3. Fully open/close arm by turning the Open/Close switch.

TREE REMOVAL

1. Attach machine to skid steer.
2. Orientate machine close to terrain.
3. Fully open arm.
4. Center the tree trunk in the middle of the transplanter system.
5. Fully close arm.
6. Begin to lower each shovel blade into terrain.

To prevent machine from unintentional elevation during tree removal, remember to retract blades after each downward motion into the terrain.

7. Penetrate Shovel Blade 1 about 8 in. (203 mm) into terrain.
8. Do the same for Shovel Blade 2 and for shovel Blade 3 (one at a time).
9. Continue to move each shovel Blade 8 in. (203 mm) in rotation until depth is reached.
10. Remove tree from terrain and tilt machine back.
11. Move away from the recently created hole in the terrain.
12. Lower machine onto to level terrain and lock all brakes.
13. Remove any roots.

TREE INSTALLATION

1. Align machine and tree above the hole.
2. Tilt and lower machine and tree into hole.
3. Raise each shovel blade one at a time out of the hole.
4. Distance the machine away from terrain.
5. Fully open arm.
6. Move away from the area.



BASKETING A TREE

When basketing a tree, keep in mind that it will be much easier to handle the tree in a basket if it is in the same hole, it was taken out of.

Remember most baskets are flat on the bottom. For the operator to get a flat cone, they will

need to slightly retract each shovel blade. Doing so will allow the root ball to fit inside of the basket.

MAINTENANCE INSTRUCTIONS

Regular maintenance is the key to keeping the machine functioning properly, for your safety please read and follow the instructions below:

MAINTENANCE

1. Check all the fasteners if any are loose then tighten them.
2. Check the hydraulic system for any leaks. If any are leaking or are cracked replace parts.
3. Check all parts for damage. If damage is found replace part or parts that are affected.
4. After each operation, make sure to clean the dirt of each shovel blade to prevent future issues.
5. When performing Maintenance on machine, be sure to place a "Servicing" or "under Maintenance" tag to let other operators know to no approach the skid steer or turn it on.
6. Only use manufacturer-approved parts to replace damaged parts.

LUBRICATION

1. Lower machine to terrain.
2. Check that all breaks are engaged.
3. Pump grease into all grease fittings at both ends to prevent premature expiration of parts.
4. Below you will see all 6 grease points.



TROUBLESHOOTING

PROBLEM	PROBABLE CAUSE	SOLUTION
Shovel Blade will not cut into terrain	Low pressure	Check oil level add more if low
	Hydraulic Hose not attached correctly	check connection and reverse
	Slides have dirt in them	Clean Slides
Shovel Blade Lifts off the terrain when extending	Started with farthest Shovel Blade	Start with Closest shovel Blade
	Terrain could be dry	Wait for terrain to become moist

PARTS DIAGRAM / EXPLODED VIEW

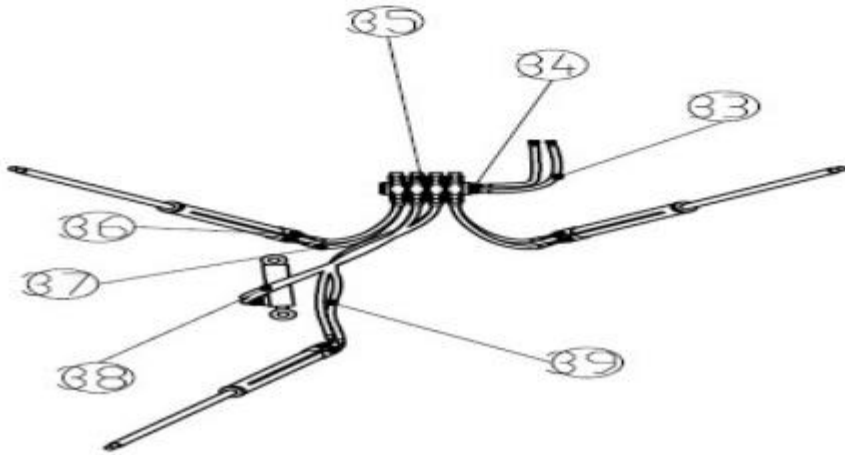
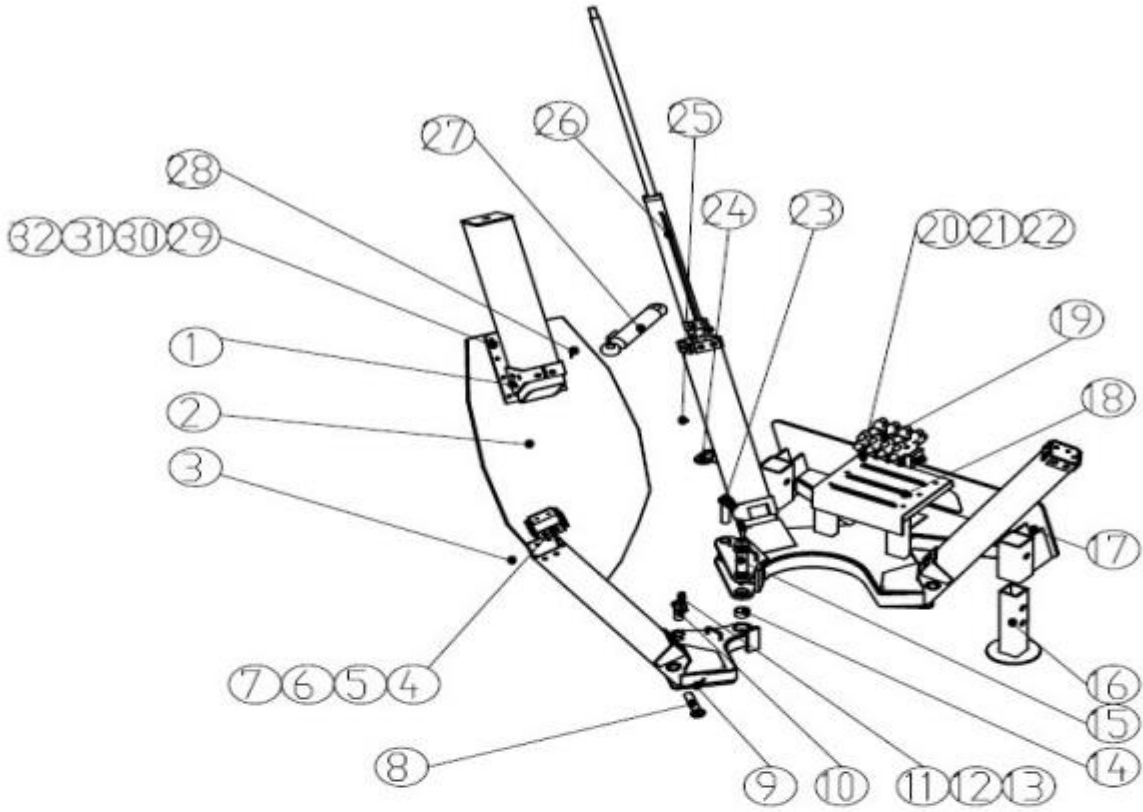

PARTS LIST

NO	PART NO.	NAME	QTY	NOTE
1	050236-01	ARM	3	
2	050236-02	SHOVEL BLADE	3	
3	050236-03	SOCKET HEAD CAP SCREW M8X12	24	
4	050236-04	WEAR PLATE A	3	
5	050236-05	WEAR PLATE B	3	
6	050236-06	WEAR PLATE C	6	
7	050236-07	WEAR PLATE D	12	
8	050236-08	HINGE PIN	3	
9	050236-09	ROTATING ELEMENT	1	
10	050236-10	HINGE PIN	1	
11	050236-11	HEX BOLT M12X25	3	
12	050236-12	FLAT WASHER 12	3	
13	050236-13	SPRING WASHER 12	3	
14	050236-14	SELF-LUBRICATING BEARING	2	
15	050236-15	HINGE PIN	1	
16	050236-16	OUTRIGGER	2	
17	050236-17	FRAME	1	
18	050236-18	FOOTSTEP	1	
19	050236-19	VALVE BLOCK	1	
20	050236-20	HEX BOLT M10X25	6	
21	050236-21	FLAT WASHER 10	6	
22	050236-22	SPRING WASHER 10	6	
23	050236-23	HINGE PIN	1	
24	050236-24	HINGE PIN	2	
25	050236-25	SOCKET HEX BOLT M8X16	36	
26	050236-26	ARM CYLINDER	3	
27	050236-27	ROTATING CYLINDER	1	
28	050236-28	FLAT WASHER 30	3	
29	050236-29	HEX BOLT M12X40	24	
30	050236-30	FLAT WASHER 12	24	
31	050236-31	SPRING WASHER 12	24	

32	050236-32	HEX BOLT M12	24	
33	050236-23	TUBE	2	
34	050236-34	HORSE COUPLER A	2	
35	050236-39	SOLENOID VALVES	4	
36	050236-38	TUBE B	16	
37	050236-35	TUBE A	4	
38	050236-36	TUBE B	2	
39	050236-37	TUBE C	2	

ACKNOWLEDGEMENT OF RISK AND RELEASE OF LIABILITY

The use of any equipment, including this one, involves the potential risk of injury. Apart from any warranty claim that might be presented for a claimed defect in material or workmanship of the product, you accept and assume full responsibility for any and all injuries, damages (both economic and non-economic), and losses of any type, which may occur, and you fully and forever release and discharge Titan, its insurers, employees, officers, directors, associates, and agents from any and all claims, demands, damages, rights of action, or causes of action, present or future, whether the same be known or unknown, anticipated, or unanticipated, resulting from or arising out of the use of said equipment.

This equipment must be used with care by capable and competent individuals under supervision, if necessary.

WARNING



Do not overfill! Mower should be level when checking oil in gear box.



some activities might be able to cause electric shock



Sharp objects may be involved.
Use protective cover during maintenance.

TITAN LIMITED WARRANTY: TERMS, EXCLUSIONS AND LIMITATIONS OF REMEDIES

This product comes with a one (1) year limited warranty that can be found at www.palletforks.com/warranty.html. Please review the same for all details regarding the Titan Limited Warranty.

THE TITAN LIMITED WARRANTY FOUND AT WWW.PALLETFORKS.COM/WARRANTY.HTML IS EXCLUSIVE AND IS IN LIEU OF ALL OTHER WARRANTIES, EXPRESS OR IMPLIED, INCLUDING ANY IMPLIED WARRANTY OF MERCHANTABILITY AND/OR FITNESS FOR A PARTICULAR PURPOSE, EACH OF WHICH IS HEREBY DISCLAIMED.



NEED HELP? CONTACT US FIRST.

1-800-605-7595

info@palletworks.com
www.palletforks.com

© 2023 Titan Brands