

8' CRESCENT FIREWOOD RACK

CLOGRXLv2

899907

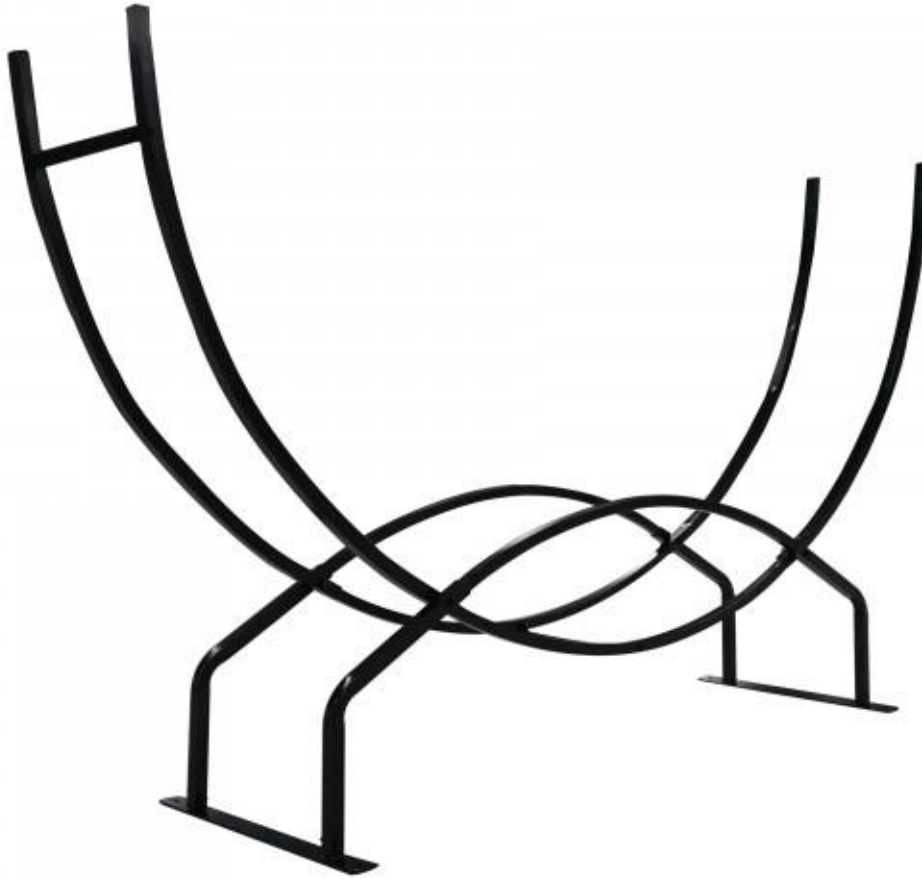

Operator's Manual



Read the Operator's Manual entirely. When you see this symbol, the subsequent instructions and warnings are serious follow without exception. Your life and the lives of others depend on it!

PARTS DIAGRAM / EXPLODED VIEW

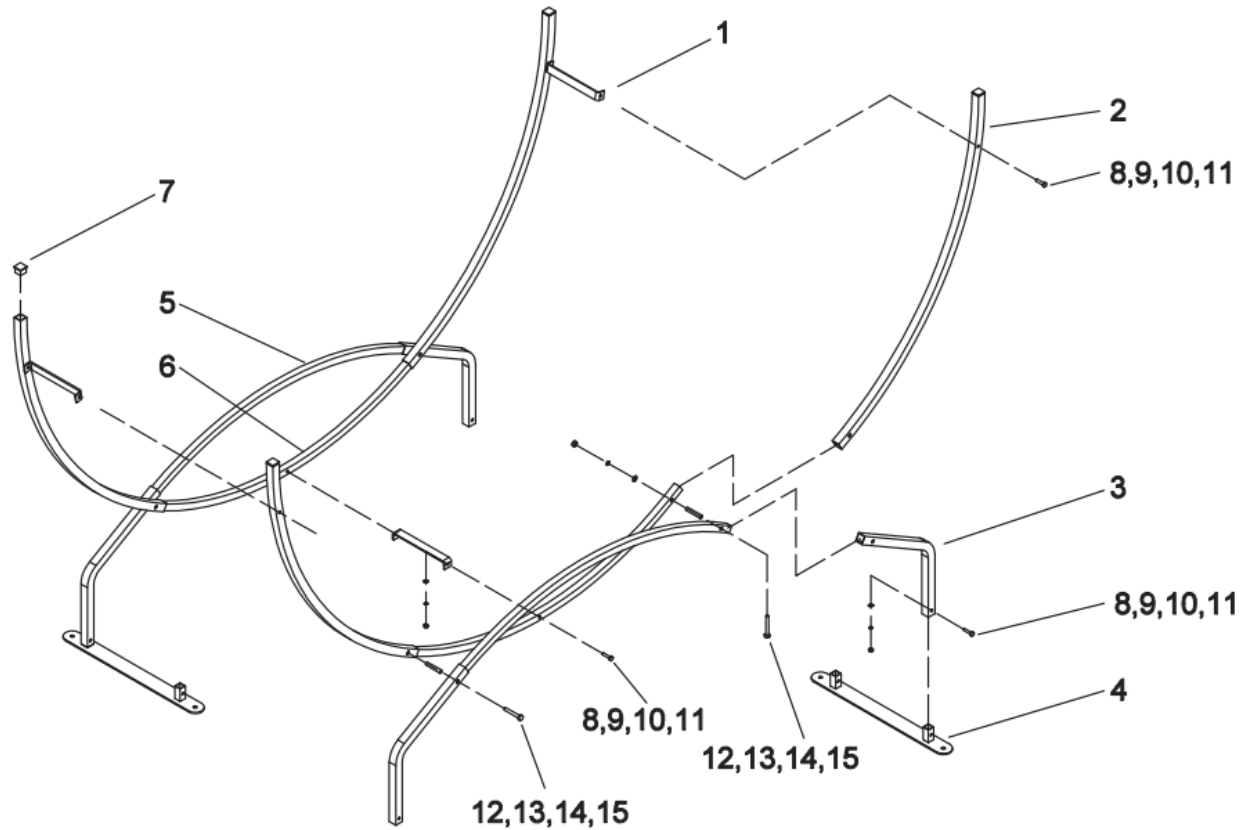

KEY	BOX	DESCRIPTION	QTY	KEY	BOX	DESCRIPTION	QTY
(1)	1	SUPPORT BLOCK	3	(9)	1	φ 8 WASHER	10
(2)	1	SIDE TUBE	4	(10)	1	φ 8 SPRING WASHER	10
(3)	1	FOOT TUBE	4	(11)	1	M8 NUT	10
(4)	1	FIXED PLATE	2	(12)	1	BOLT M10X75	4
(5)	1	INTERMEDIATE TUBE	2	(13)	1	φ 10 WASHER	4
(6)	1	PERFORATED MIDDLE	2	(14)	1	φ 10 SPRING WASHER	4
(7)	1	BULKHEAD	4	(15)	1	M10 NUT	4
(8)	1	BOLT M8X50	10				

ASSEMBLY INSTRUCTIONS

1. Slide short side of Legs (part 1) onto the Feet (part 2). Align holes, insert Short Bolt, and attach with Washer, Spring Washer, and Nut (part 4).



2. Slide Upper Tubes (part 6) into Legs (part 1). DO NOT BOLT IN YET!
3. Slide 2 Side-Wall Tubes (part 7) into each Lower Tube (part 5). DO NOT BOLT TOGETHER YET! This step should result in 2 large U-shaped crescents.

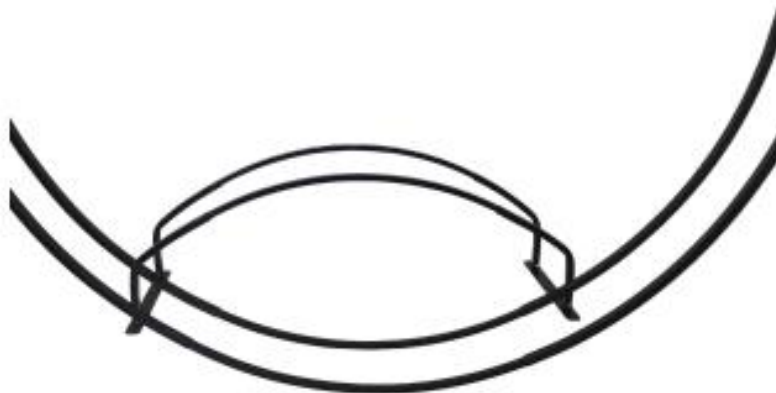

4. Bolt each U-shaped crescent to the INSIDE of your base using the Long Bolt (part 3) secured with the washer, spring washer, and nut. Hand tightens only!

ASSEMBLY INSTRUCTIONS



5. Bolt in the 3 Support Brackets (part 8) using the Short Bolts (part 4) secured with the washers, spring washers, and nuts. Tighten down fully using a wrench.
6. Once you have ensured all tubes are seated and aligned properly, go back, and tighten all remaining bolts with a wrench. Be careful not to over-tighten as this could damage the tubing.

ACKNOWLEDGEMENT OF RISK AND RELEASE OF LIABILITY

The use of any equipment, including this one, involves the potential risk of injury. Apart from any warranty claim that might be presented for a claimed defect in material or workmanship of the product, you accept and assume full responsibility for any and all injuries, damages (both economic and non-economic), and losses of any type, which may occur, and you fully and forever release and discharge Titan, its insurers, employees, officers, directors, associates, and agents from any and all claims, demands, damages, rights of action, or causes of action, present or future, whether the same be known or unknown, anticipated, or unanticipated, resulting from or arising out of the use of said equipment.

This equipment must be used with care by capable and competent individuals under supervision, if necessary.

WARNING



Heavy object. Use lifting aids and proper lifting techniques when moving.



Choking hazard. Small parts - Please exercise caution if small children or pets are present.



Sharp objects may be involved. Use precaution and protection.

TITAN LIMITED WARRANTY: TERMS, EXCLUSIONS AND LIMITATIONS OF REMEDIES

This product comes with a one (1) year limited warranty that can be found at www.titangreatoutdoors.com/warranty.html. Please review the same for all details regarding the Titan Limited Warranty.

THE TITAN LIMITED WARRANTY FOUND AT WWW.TITANGREATOUTDOORS.COM/WARRANTY.HTML IS EXCLUSIVE AND IS IN LIEU OF ALL OTHER WARRANTIES, EXPRESS OR IMPLIED, INCLUDING ANY IMPLIED WARRANTY OF MERCHANTABILITY AND/OR FITNESS FOR A PARTICULAR PURPOSE, EACH OF WHICH IS HEREBY DISCLAIMED.



NEED HELP? CONTACT US FIRST.

1-888-794-1455

info@titangreatoutdoors.com

www.titangreatoutdoors.com

© 2021 Titan Brands