

BOLT-ON GRAPPLE ATTACHMENT

BOG4860, BOG6072, BOG7284

111307, 111305, 111308



Operator's Manual

Read the Operator's Manual entirely. When you see this symbol, the subsequent instructions and warnings are serious follow without exception. Your life and the lives of others depend on it!

BOG4860 PARTS DIAGRAM / EXPLODED VIEW

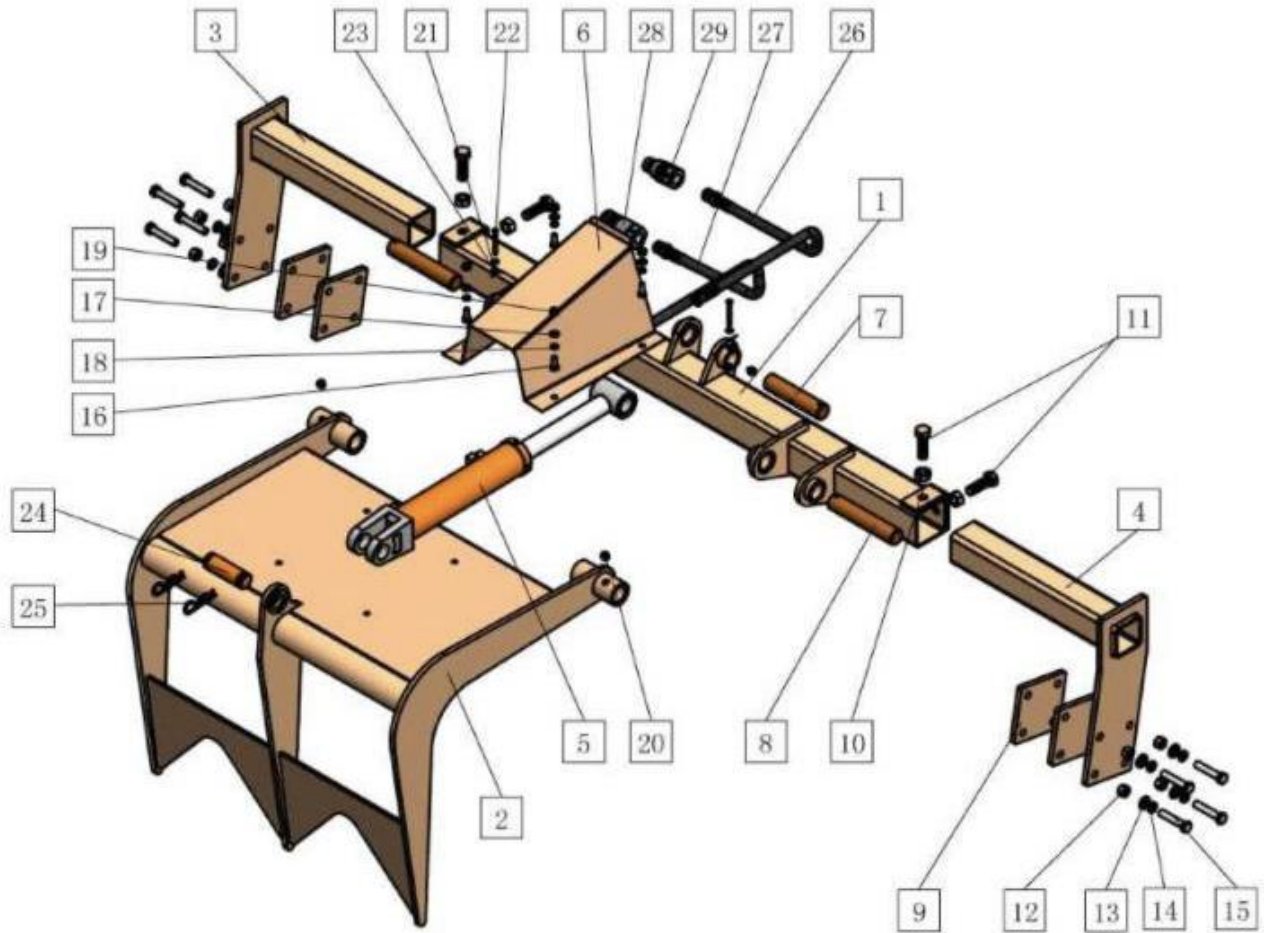

KEY	DESCRIPTION	QTY	KEY	DESCRIPTION	QTY
(1)	MAIN SUPPORT TUBE	x1	(16)	M8x20 HEX BOLT	x4
(2)	UPPER JAW	x1	(17)	8 FLAT WASHER	x4
(3)	LEFT ARM	x1	(18)	8 SPRING WASHER	x4
(4)	RIGHT ARM	x1	(19)	M8 HEX NUT	x4
(5)	CYLINDER	x1	(20)	GREASE NOZZLE	x3
(6)	CYLINDER SHIELD	x1	(21)	6 FLAT WASHER	x3
(7)	PIN SHAFT - 1	x1	(22)	A6x50 LOCK PIN	x3
(8)	PIN SHAFT - 2	x2	(23)	COTTER PIN	x3
(9)	LOCK PLATE	x4	(24)	PIN SHAFT - 3	x1
(10)	M16 HEX NUT	x4	(25)	B-SHAPE PIN	x2
(11)	M16x50 HEX BOLT	x4	(26)	OIL HOSE RETURN	x1
(12)	M12 HEX NUT	x8	(27)	OIL HOSE INLET	x1
(13)	12 FLAT WASHER	x8	(28)	FLAT FACE COUPLER - F	x1
(14)	12 SPRING WASHER	x8	(29)	FLAT FACE COUPLER - M	x1
(15)	M12x60 HEX BOLT	x8			

ASSEMBLY INSTRUCTIONS

– COMES FULLY ASSEMBLED

BOG6072 & BO7284 PARTS DIAGRAM / EXPLODED VIEW

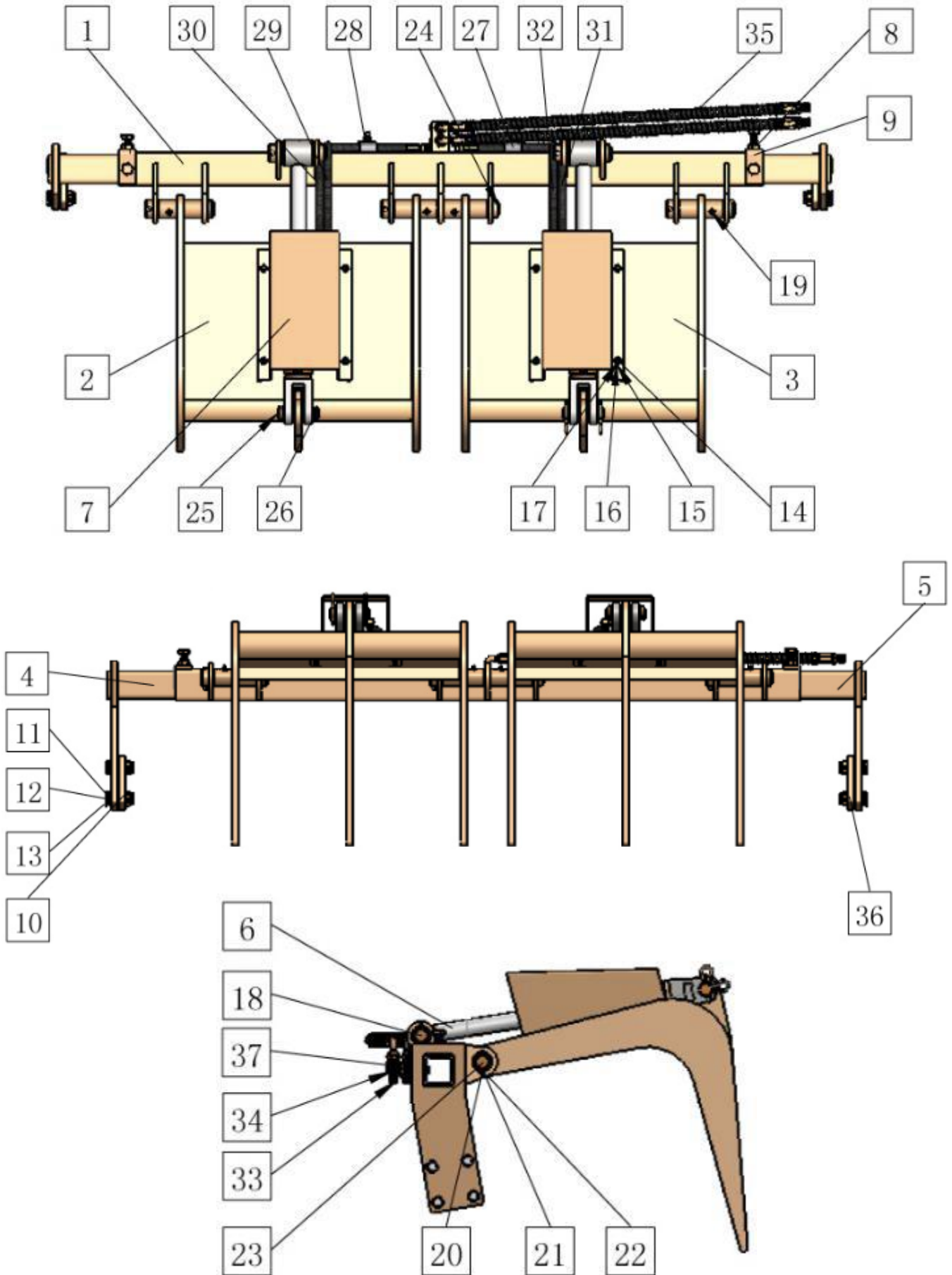

KEY #	DESCRIPTION	QTY	KEY #	DESCRIPTION	QTY
(1)	UPPER BAR	X1	(20)	M6 FLAT WASHER (LOCK PIN)	X5
(2)	RIGHT JAW	X1	(21)	A6X50 LOCK PIN	X5
(3)	LEFT JAW	X1	(22)	COTTER PIN 1.6X590	X5
(4)	LEFT ARM	X1	(23)	PIN SHAFT - 2 DIA 30	X2
(5)	RIGHT ARM	X1	(24)	PIN SHAFT - 3 DIA 30	X1
(6)	CYLINDER (165MM STROKE)	X2	(25)	PIN SHAFT DIA 32	X2
(7)	CYLINDER SHIELD	X1	(26)	B-SHAPED PIN 3.7X65	X4
(8)	M16 HEX NUT	X4	(27)	OIL HOSE CLIP - PLASTIC	X2
(9)	M16X50 HEX BOLT	X4	(28)	M10 HEX LOCK NUT	X2
(10)	M12 HEX NUT	X8	(29)	OIL HOSE - INLET 1	X1
(11)	M12 FLAT WASHER	X8	(30)	OIL HOSE - OUTLET 1	X1
(12)	M12 SPRING WASHER	X10	(31)	OIL HOSE - OUTLET 2	X1
(13)	M12X60 HEX BOLT	X8	(32)	OIL HOSE - INLET 2	X1
(14)	M8X20 HEX BOLT	X8	(33)	T-CONNECTOR	X2
(15)	M8 FLAT WASHER	X8	(34)	G3-8 HEX THIN NUT	X4
(16)	M8 SPRING WASHER	X8	(35)	MAIN OIL HOSE	X2
(17)	M8 HEX NUT	X8	(36)	T-16 LOCK PLATE	X2
(18)	PIN SHAFT - 1 DIA 30	X2	(37)	M16 SPRING WASHER	X2
(19)	GREASE NOZZLE	X6			

ASSEMBLY INSTRUCTIONS

- COMES FULLY ASSEMBLED

ACKNOWLEDGEMENT OF RISK AND RELEASE OF LIABILITY

The use of any equipment, including this one, involves the potential risk of injury. Apart from any warranty claim that might be presented for a claimed defect in material or workmanship of the product, you accept and assume full responsibility for any and all injuries, damages (both economic and non-economic), and losses of any type, which may occur, and you fully and forever release and discharge Titan, its insurers, employees, officers, directors, associates, and agents from any and all claims, demands, damages, rights of action, or causes of action, present or future, whether the same be known or unknown, anticipated, or unanticipated, resulting from or arising out of the use of said equipment.

This equipment must be used with care by capable and competent individuals under supervision, if necessary.

WARNING



Do not overfill! Mower should be level when checking oil in gear box.



some activities might be able to cause electric shock



Sharp objects may be involved.
Use protective cover during maintenance.

TITAN LIMITED WARRANTY: TERMS, EXCLUSIONS AND LIMITATIONS OF REMEDIES

This product comes with a one (1) year limited warranty that can be found at www.palletforks.com/warranty.html. Please review the same for all details regarding the Titan Limited Warranty.

THE TITAN LIMITED WARRANTY FOUND AT WWW.PALLETFORKS.COM/WARRANTY.HTML IS EXCLUSIVE AND IS IN LIEU OF ALL OTHER WARRANTIES, EXPRESS OR IMPLIED, INCLUDING ANY IMPLIED WARRANTY OF MERCHANTABILITY AND/OR FITNESS FOR A PARTICULAR PURPOSE, EACH OF WHICH IS HEREBY DISCLAIMED.



NEED HELP? CONTACT US FIRST.

1-800-605-7595

info@palletworks.com
www.palletforks.com

© 2023 Titan Brands