

TELEHANDLER SAFETY MANBASKET

TLEBSK4X6, TLEBSK4X78

190502, 190521



Operator's Manual



Read the Operator's Manual entirely. When you see this symbol, the subsequent instructions and warnings are serious follow without exception. Your life and the lives of others depend on it!

THESE ARE STANDARD PRACTICES THAT MAY NOT APPLY TO THE PRODUCTS DESCRIBED IN THIS MANUAL.

PRECAUTIONS

- This manual is made at the time of manufacturing of the work platform that does not include any subsequent modifications made afterward.
- This manual is intended to provide information to operators and owners to operate the work platform safely and effectively, as well as to perform suitable maintenance for the work platform.
- Before operating or performing maintenance of the work platform, it is critical to read, understand and be acquainted with the operating, safety, and maintenance recommendations of this manual, as well as the manual of your forklift or telehandler.
- Failure in operating and maintaining the work platform according to the instructions and recommendations could lead to fatal accident causing serious personal injury or death.

SAFETY PRECAUTIONS



THIS SYMBOL BY ITSELF OR WITH A WARNING WORD THROUGHOUT THIS MANUAL IS USED TO CALL YOUR ATTENTION TO INSTRUCTIONS INVOLVING YOUR PERSONAL SAFETY OR THE SAFETY OF OTHERS. FAILURE TO FOLLOW THESE INSTRUCTIONS CAN RESULT IN INJURY OR DEATH.

DANGER

THIS SIGNAL WORD IS USED WHERE SERIOUS INJURY OR DEATH WILL RESULT IF THE INSTRUCTIONS ARE NOT FOLLOWED PROPERLY.

WARNING

THIS SIGNAL WORD IS USED WHERE SERIOUS INJURY OR DEATH WILL RESULT IF THE INSTRUCTIONS ARE NOT FOLLOWED PROPERLY.

CAUTION

THIS SIGNAL WORD IS USED WHERE SERIOUS INJURY OR DEATH WILL RESULT IF THE INSTRUCTIONS ARE NOT FOLLOWED PROPERLY.

ASSEMBLY INSTRUCTIONS

SPECIAL NOTES:

- Build on flat and level ground
- Avoid tightening bolts down completely until the rack is fully assembled
- Reference positions: left/right/front/back are from forklift cab viewing the work platform

STEP 1: INSTALLING CORNER FRAMES

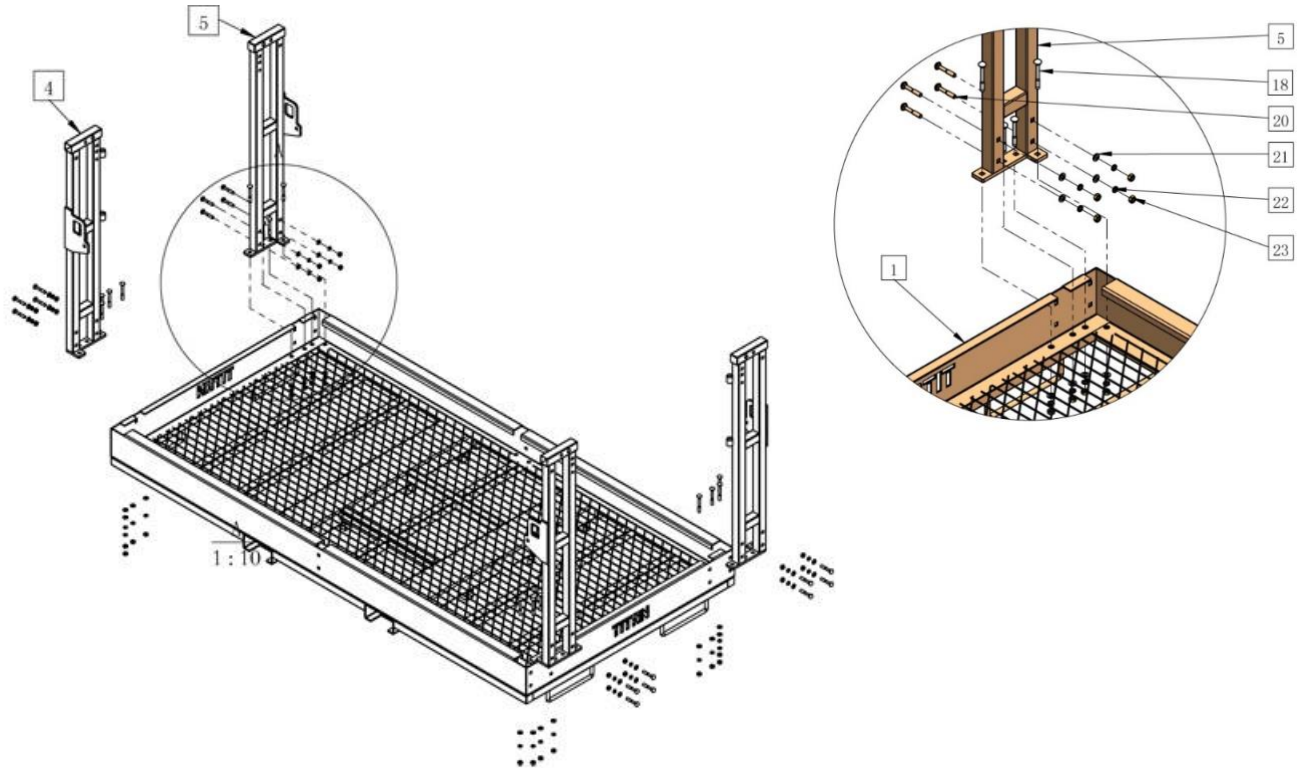

| KEY | DESCRIPTION | QTY | KEY | DESCRIPTION | QTY |
|------|----------------------|-----|------|----------------------|-----|
| (1) | BASE ASSY | 1 | (20) | CARRIAGE BOLT M10x60 | 16 |
| (4) | CORNER FRAME-1 | 2 | (21) | FLAT WASHER M10 | 32 |
| (5) | CORNER FRAME-2 | 2 | (22) | SPRING WASHER M10 | 32 |
| (18) | CARRIAGE BOLT M10x80 | 16 | (23) | HEX NUT M10 | 32 |

STEP 1: INSTALLING CORNER FRAMES

1. Rest **CORNER FRAME-1 (4)** on the left/front corner of the **BASE ASSY (1)** and align bolt holes. Insert **CARRIAGE BOLT M10x60 (20)** through the holes from the side and place **FLAT WASHER M10 (21)**, **SPRING WASHER M10 (22)** and **HEX NUT M10 (23)** onto the end of the bolt. Then insert **CARRIAGE BOLT M10x80 (18)** through the bolt holes from the top and place **FLAT WASHER M10 (21)**, **SPRING WASHER M10 (22)** and **HEX NUT M10 (23)** onto the end of the bolt.

FASTEN BUT DO NOT TIGHTEN HARDWARE.

2. Repeat the above procedures for mounting the second **CORNER FRAME-1 (4)** on the right/back diagonal corner of the **BASE ASSY (1)**.
3. Rest **CORNER FRAME-1 (5)** on the right/front corner of the **BASE ASSY (1)** and align bolt holes. Insert **CARRIAGE BOLT M10x60 (20)** through the holes from the side and place **FLAT WASHER M10 (21)**, **SPRING WASHER M10 (22)** and **HEX NUT M10 (23)** onto the end of the bolt. Then insert **CARRIAGE BOLT M10x80 (18)** through the bolt holes from the top and place **FLAT WASHER M10 (21)**, **SPRING WASHER M10 (22)** and **HEX NUT M10 (23)** onto the end of the bolt. Fasten but do not tighten hardware.
4. Repeat the above procedures for mounting the second **CORNER FRAME-1 (5)** on the left/back diagonal corner of the **BASE ASSY (1)**.

STEP 2: INSTALLING GUARD RAILS

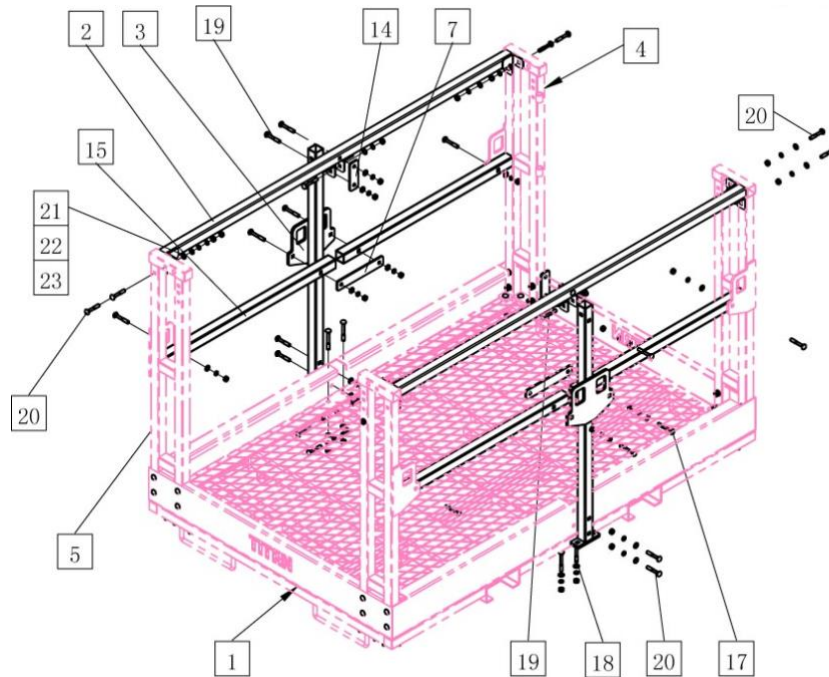

| KEY | DESCRIPTION | QTY | KEY | DESCRIPTION | QTY |
|------|-------------------------|-----|------|----------------------|-----|
| (1) | BASE ASSY | 1 | (17) | CARRIAGE BOLT M10x70 | 4 |
| (2) | TOP GUARD RAIL | 2 | (18) | CARRIAGE BOLT M10x80 | 20 |
| (3) | UPRIGHT POST ASSY | 2 | (19) | CARRIAGE BOLT M10x65 | 10 |
| (4) | CORNER FRAME-1 | 2 | (20) | CARRIAGE BOLT M10x60 | 28 |
| (5) | CORNER FRAME-2 | 2 | (21) | FLAT WASHER M10 | 62 |
| (7) | RAIL MOUNTING PLATE - 1 | 2 | (22) | SPRING WASHER M10 | 62 |
| (14) | RAIL MOUNTING PLATE -2 | 2 | (23) | HEX NUT M10 | 62 |
| (15) | CENTER GUARD RAIL | 4 | | | |

STEP 2: INSTALLING GUARD RAILS

1. Rest **UPRIGHT POST ASSY (3)** on the middle of the **BASE ASSY (1)** and align bolt holes. Insert **CARRIAGE BOLT M10x80 (18)** through the bolt holes from the top and place **FLAT WASHER M10 (21)**, **SPRING WASHER M10 (22)** and **HEX NUT M10 (23)** onto the end of the bolt. Then insert **CARRIAGE BOLT M10x60 (20)** through the holes from the side and place **FLAT WASHER M10 (21)**, **SPRING WASHER M10 (22)** and **HEX NUT M10 (23)** onto the end of the bolt.
FASTEN BUT DO NOT TIGHTEN HARDWARE.
2. Repeat the above procedures for mounting the second **UPRIGHT POST ASSY (3)** onto the **BASE ASSY (1)**.
3. Attach **CENTER GUARD RAIL (15)** to the center of **CORNER FRAME-1 (4)** and **CORNER FRAME-2 (5)** respectively using **CARRIAGE BOLT M10x60 (20)**, **FLAT WASHER M10 (21)**, **SPRING WASHER M10 (22)** and **HEX NUT M10 (23)**. The order of assembly is to push **CARRIAGE BOLT M10x60 (20)** through the holes and then place **FLAT WASHER M10 (21)**, **SPRING WASHER M10 (22)** and **HEX NUT M10 (23)** onto the end of the bolt.
FASTEN BUT DO NOT TIGHTEN HARDWARE.
4. Attach **CENTER GUARD RAIL (15)** to the center of **UPRIGHT POST ASSY (3)** using **RAIL MOUNTING PLATE - 1 (7)**, **CARRIAGE BOLT M10x70 (17)**, **FLAT WASHER M10 (21)**, **SPRING WASHER M10 (22)** and **HEX NUT M10 (23)**. Repeat the above procedures for mounting the second **CENTER GUARD RAIL (15)** on the other face.
5. Attach the 2 ends of **TOP GUARD RAIL (2)** to using **CORNER FRAME-1 (4)** and **CORNER FRAME-2 (5)** respectively using **CARRIAGE BOLT M10x60 (20)**, **FLAT WASHER M10 (21)**, **SPRING WASHER M10 (22)** and **HEX NUT M10 (23)**.
6. Attach the center of **TOP GUARD RAIL (2)** to the center of **UPRIGHT POST ASSY (3)** using **RAIL MOUNTING PLATE -2 (14)**, **CARRIAGE BOLT M10x65 (19)**, **FLAT WASHER M10 (21)**, **SPRING WASHER M10 (22)** and **HEX NUT M10 (23)**. Repeat the above procedures for mounting the second **TOP GUARD RAIL (2)** on the other face.

STEP 3: INSTALLING GATES AND FINAL TOUCH

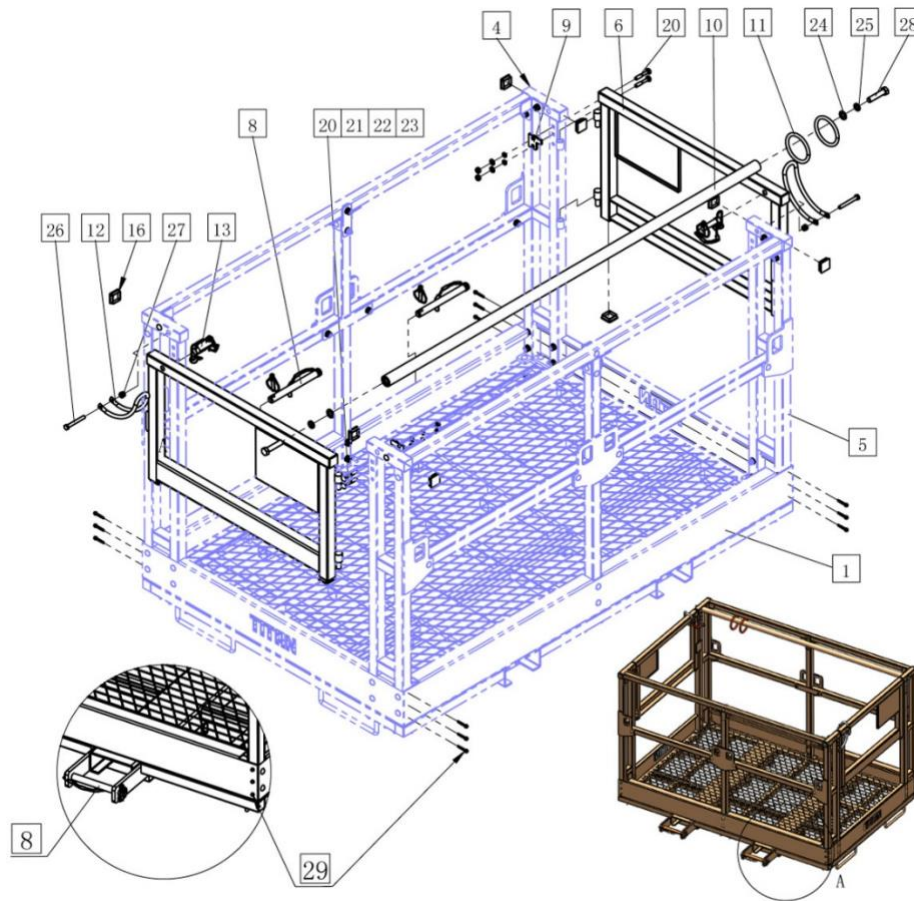

| KEY | DESCRIPTION | QTY | KEY | DESCRIPTION | QTY |
|------|--------------------------|-----|------|----------------------|-----|
| (1) | BASE ASSY | 1 | (20) | CARRIAGE BOLT M10x60 | 4 |
| (4) | CORNER FRAME-1 | 2 | (21) | FLAT WASHER M10 | 4 |
| (5) | CORNER FRAME-2 | 2 | (22) | SPRING WASHER M10 | 4 |
| (6) | GATE FRAME | 2 | (23) | HEX NUT M10 | 4 |
| (8) | LOCK PIN ASSY - FORK (8) | 2 | (24) | FLAT WASHER M16 | 2 |
| (9) | GATE SWING STOPPER | 2 | (25) | SPRING WASHER M16 | 2 |
| (10) | HARNESS SAFETY BAR | 1 | (26) | HEX BOLT M10x80 | 2 |
| (11) | HARNESS LOCK RING | 1 | (27) | HEX LOCK NUT M10 | 2 |
| (13) | GATE LOCK SAFETY PIN | 2 | (28) | HEX BOLT M16x80 | 2 |
| (16) | TUBE END PLASTIC CAP | 12 | (29) | SELF TAPING BOLT | 12 |

STEP 3: INSTALLING GATES AND FINAL TOUCH

1. Attach **GATE SWING STOPPER (9)** onto **CORNER FRAME-1 (4)** or **CORNER FRAME-2 (5)** using **CARRIAGE BOLT M10x60 (20)**, **FLAT WASHER M10 (21)**, **SPRING WASHER M10 (22)**, and **HEX NUT M10 (23)**. The order of assembly is to push **CARRIAGE BOLT M10x60 (20)** through these parts, and then **FLAT WASHER M10 (21)**, **SPRING WASHER M10 (22)**, and **HEX NUT M10 (23)** onto the end of the bolt. Fasten hardware but do not tighten. Repeat the same procedures to mount the **STOPPERS** onto all 4 **CORNER FRAMEs**.
2. Plug **TUBE END PLASTIC CAP (16)** into all open tube ends of **CORNER FRAMEs** and **DOOR FRAMEs (6)**.
3. Insert two **HARNES LOCK RING (11)** into **HARNES SAFETY BAR (10)** and attached the ends of the **HARNES SAFETY BAR (10)** onto the rear **DOOR FRAME (6)** and **CORNER FRAME-2 (5)** using **FLAT WASHER M16 (24)**, **SPRING WASHER M16 (25)**, and **HEX BOLT M16x80 (28)**. The order of assembly is to insert **SPRING WASHER M10 (22)** and **FLAT WASHER M10 (21)** into **HEX BOLT M16x80 (28)**.
FASTEN HARDWARE BUT DO NOT TIGHTEN.
4. Mount **GATE LATCH (12)** onto **CORNER FRAME-2 (5)** at the front and rear faces of the work platform using **HEX BOLT M10x80 (26)** and **HEX LOCK NUT M10 (27)**. The order of assembly is to insert **HEX BOLT M10x80 (26)** through these parts and fasten with **HEX LOCK NUT M10 (27)**, but do not tighten.
5. Insert the hinge shaft of **GATE FRAME (6)** into the shaft sleeve of **GATE FRAME (6)** . Do this for both the front and rear faces of the work platform. Close the gates with the gate latch and lock both gates with **GATE LOCK SAFETY PIN (13)** on the opposite sides.
6. Insert **LOCK PIN ASSY – FORK (8)** into the pin brackets at the **BASE ASSY (1)** bottom fork channels.
7. Tighten all hardware gradually and adjust make sure that all sides of the work platform is square and level. Use levelling gauge wherever necessary. When squareness and levelling of the work platform is assured and all hardware has been tightened, mount three **SELF TAPING BOLT (29)** on each of the edges of the front and rear faces as shown in the above diagram of the **BASE ASSY (1)** to reinforce the whole structure.

OPERATION INSTRUCTIONS

- Work platform operator must acquire appropriate qualification or license to work in elevated height according to requirements of local regulations.
- Forklift or telehandler operator must acquire appropriate qualification or license and fully trained to maneuver elevated loads.
- Operator must be mentally sound and not being affected by drugs or alcoholic drinks during operating the equipment. Alcohol and drugs could reduce alertness and coordination causing catastrophic accident with serious personal injury or death. An operator taking prescription or over the counter drugs should seek medical advice as to whether he or she can safely operate the equipment.
- Work platform operator must put on OSHA safety lanyard or harness that is locked in place to the harness ring of the platform.

ENVIRONMENTAL FACTORS

- Avoid working in bad weather including but not limited to heavy rain, snowing, stormy and windy weather.
- Do not operate in environment that is not well-lit.
- Avoid working on a slope, uneven and slippery ground. Make sure the ground is solid enough to hold the forklift or telehandler stably and use outrigger if available.
- Beware of overhead power, communication lines and other obstacles to plan safe lifting.

INSPECTIONS BEFORE USE

- Make sure that the forklift or telehandler can be stopped quickly in case of emergency.
- Check structural integrity of platform including, damaged, deformed and wearing of parts and hardware, cracks in welds, and excessive erosions caused by rusting. Replace or repair if necessary.
- Check for loosen bolts, nuts and pins and tighten.
- Double check gate latch can be locked securely.
- Double if guard rails are tightly locked onto the work platform.
- Check communication link between forklift operator and personnel on platform is in good order.

USING THE WORK PLATFORM

- Make sure that the work area is in good working conditions as stated in the previous **ENVIRONMENTAL FACTOR** section, and all necessary inspections stated in the previous **INSPECTION BEFORE USE** section is satisfactorily performed.
- Insert the fork tines fully into the fork channels and secure the fork heel tightly against the safety pins. Double check if the fork is locked tightly without allowing movements.



- Move forklift to designated lifting position and make sure that the forklift or telehandler is in parking brake (engage outrigger if available) before elevating personnel.
- Platform personnel should enter work platform on ground. After entering platform, engage the gate latch and safety pin and make sure the gates are locked securely. Put on safety lanyard or harness and lock it on the harness ring before signaling forklift operator to elevate.

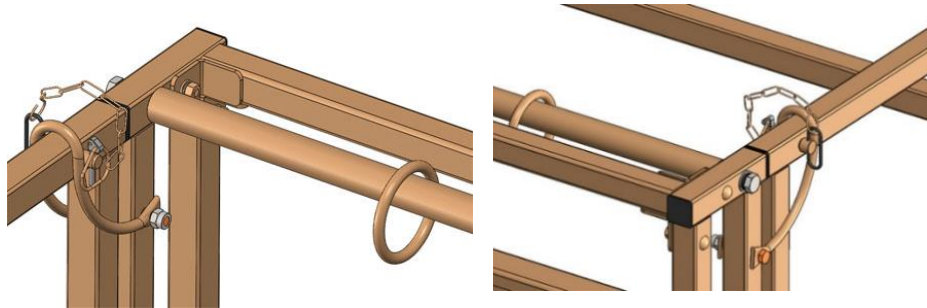

- When personnel are inside the work platform, elevate or lower the work platform vertically and level with ground. Perform lifting, lowering and adjustment slowly and safely.
- Never tilt or turn the work platform when personnel are inside. If tilt or turn functions are available, the tilt and swing cylinder hydraulics must be disengaged.
- Disengage the lifting/lowering hydraulic when the work platform reached the designated height.
- Always check if effective communication channel is established in elevated position with the forklift operator before working on the work platform.
- Never use the forklift or telehandler to transfer or transport personnel in work platform.
- Whenever moving the forklift is necessary, always lower the personnel to ground to exit the work platform.
- The forklift or telehandler operator must remain all the time in the cab and be alert of the personnel in the work platform and the surrounding environment.
- Avoid bystanders, pets or livestock entering into the work area.
- Avoid leaning on guard rails freely during working on the work platform.
- Never exceed the load capacity of the work platform as stated in the **SPECIFICATIONS** Section below.

AFTER USE AND MAINTENANCE

- Only qualified personnel should make repairs to the work platform. After completing repair and maintenance, check if the work platform is in good conditions.
- Inspection and maintenance can only be conducted with engine turned off and auxiliary pressure completely disengaged.
- Lower the work platform to flat ground and let off personnel from the work platform.
- Put on personal protective equipment and apparel.
- Each time after use, clean the work platform thoroughly and remove all debris and dirt.
- Visually inspect if there are any parts damaged or deformed, repair and replace if necessary.

Check if there is any loosen or damaged hardware, tighten or replace hardware is necessary.

The minimum torque for tightening hardware is shown below:

- M10: 37 lb. Ft (50 N.m)
- M16: 163 lb. Ft (220 N.m)

When the work platform is dry, check places where paint is scratched or worn and repaint if necessary. Apply antirust oil to surface where necessary.

Store the work platform in shed and dry place.

SPECIFICATIONS

| | TLEBS 4X6 | TLEBSK4X8 | TLEBSK4X98 |
|---------------------------------------|----------------------------|----------------------------|-----------------------------|
| OVERALL DIMENSIONS (L X W X H) | 72" X 54.3" X 46.7" | 96" X 54.3" X 46.7" | 116" X 54.3" X 46.7" |
| PRODUCT WEIGHT | 485 LB. | 542 LB. | 628 LB. |
| LOAD CAPACITY | 1700 LB. | | |
| FORK CHANNEL | 6.25" X 2.5" | | |
| HANDRAIL HEIGHT | 42" | | |
| MATERIAL | STEEL | | |

Center of gravity to vertical member of fork: 27.56"

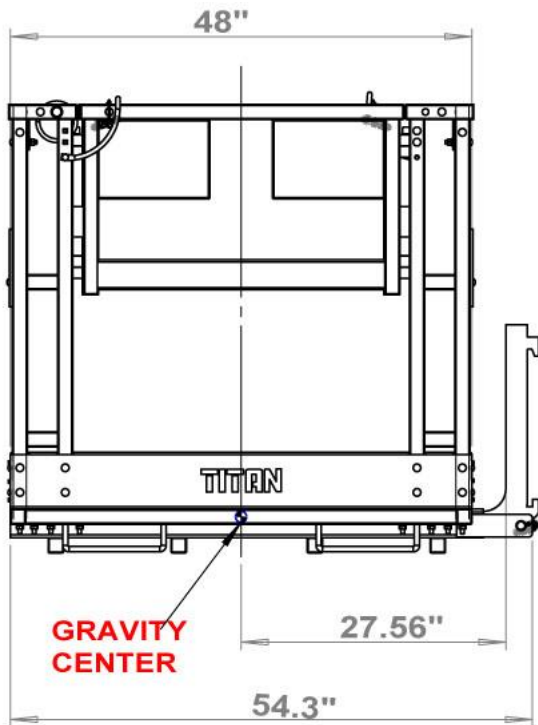

PARTS DIAGRAM / EXPLODED VIEW

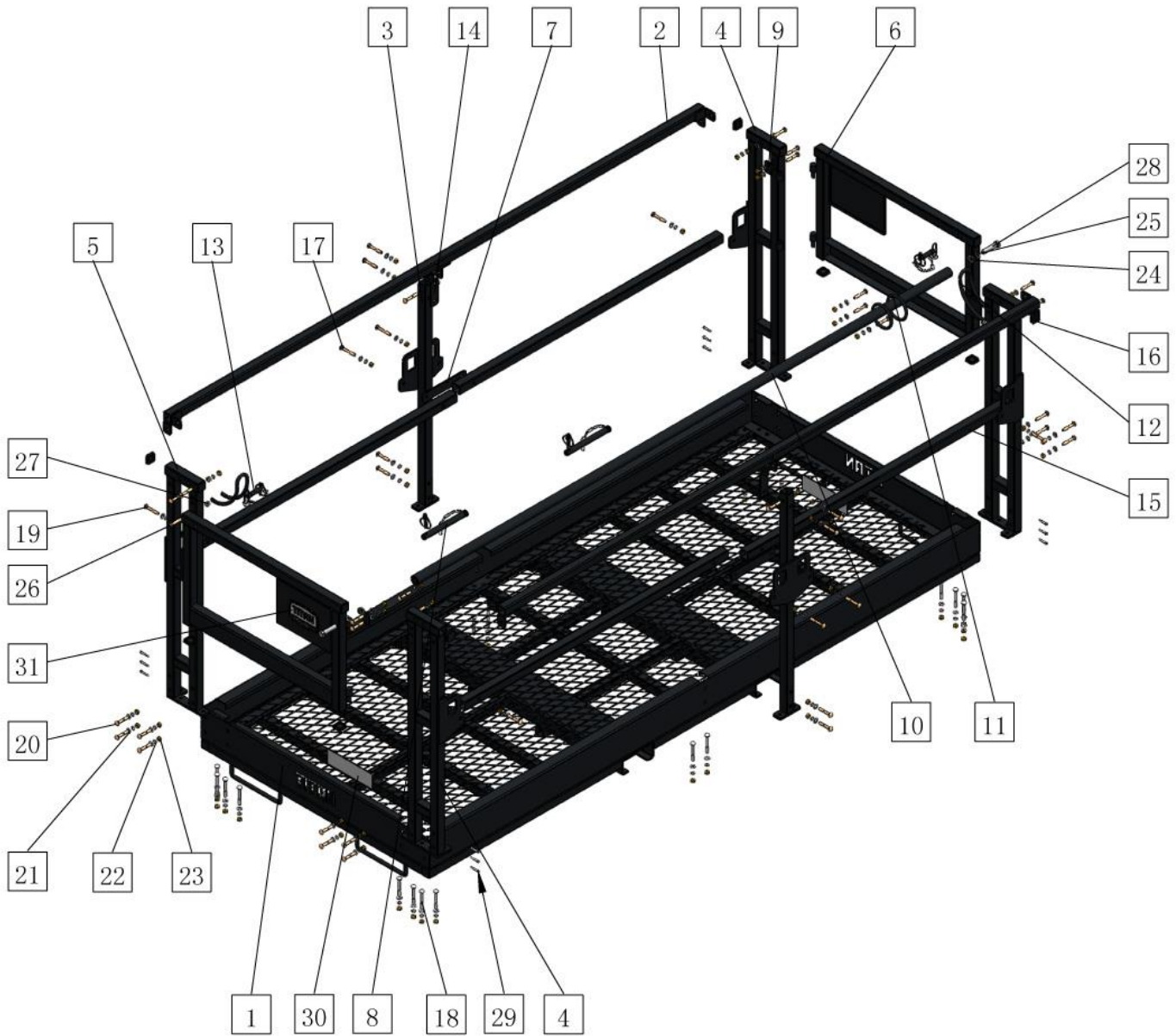

PARTS DIAGRAM / EXPLODED VIEW

| KEY | DESCRIPTION | QTY | | | |
|------|-------------------------|-----|------|-----------------------------------|----|
| (1) | BASE ASSY | 1 | (16) | TUBE END PLASTIC CAP | 8 |
| (2) | TOP GUARD RAIL | 2 | (17) | DOME HEAD CARRIAGE | 4 |
| (3) | UPRIGHT POST ASSY | 2 | (18) | DOME HEAD CARRIAGE BOLT M10x80 | 20 |
| (4) | CORNER FRAME-1 | 2 | (19) | DOME HEAD CARRIAGE BOLT M10x65 | 10 |
| (5) | CORNER FRAME-2 | 2 | (20) | DOME HEAD CARRIAGE BOLT M10x60 | 32 |
| (6) | GATE FRAME | 2 | (21) | FLAT WASHER M10 | 66 |
| (7) | RAIL MOUNTING PLATE - 1 | 2 | (22) | SPRING WASHER M10 | 66 |
| (8) | LOCK PIN ASSY - FORK | 2 | (23) | HEX NUT M10 | 66 |
| (9) | GATE SWING STOPPER | 2 | (24) | FLAT WASHER M16 | 2 |
| (10) | HARNESS SAFETY BAR | 1 | (25) | SPRING WASHER M16 | 2 |
| (11) | HARNESS LOCK RING | 2 | (26) | HEX BOLT M10x80 | 2 |
| (12) | GATE LATCH | 2 | (27) | HEX LOCK NUT M10 | 2 |
| (13) | GATE LOCK SAFETY PIN | 2 | (28) | HEX BOLT M16x80 | 2 |
| (14) | RAIL MOUNTING PLATE -2 | 2 | (29) | SELF TAPING BOLT | 12 |
| (15) | CENTER GUARD RAIL | 4 | (30) | ALUMINUM COVER PLATE | 2 |

ACKNOWLEDGEMENT OF RISK AND RELEASE OF LIABILITY

The use of any equipment, including this one, involves the potential risk of injury. Apart from any warranty claim that might be presented for a claimed defect in material or workmanship of the product, you accept and assume full responsibility for any and all injuries, damages (both economic and non-economic), and losses of any type, which may occur, and you fully and forever release and discharge Titan, its insurers, employees, officers, directors, associates, and agents from any and all claims, demands, damages, rights of action, or causes of action, present or future, whether the same be known or unknown, anticipated, or unanticipated, resulting from or arising out of the use of said equipment.

This equipment must be used with care by capable and competent individuals under supervision, if necessary.

WARNING



Do not overfill! Mower should be level when checking oil in gear box.



some activities might be able to cause electric shock



Sharp objects may be involved.
Use protective cover during maintenance.

TITAN LIMITED WARRANTY: TERMS, EXCLUSIONS AND LIMITATIONS OF REMEDIES

This product comes with a one (1) year limited warranty that can be found at www.palletforks.com/warranty.html. Please review the same for all details regarding the Titan Limited Warranty.

THE TITAN LIMITED WARRANTY FOUND AT WWW.PALLETFORKS.COM/WARRANTY.HTML IS EXCLUSIVE AND IS IN LIEU OF ALL OTHER WARRANTIES, EXPRESS OR IMPLIED, INCLUDING ANY IMPLIED WARRANTY OF MERCHANTABILITY AND/OR FITNESS FOR A PARTICULAR PURPOSE, EACH OF WHICH IS HEREBY DISCLAIMED.



NEED HELP? CONTACT US FIRST.

1-800-605-7595

info@palletworks.com
www.palletforks.com

© 2021 Titan Brands