

# REPLACEMENT TEETH FOR STANDARD SERIES SKID STEER BRUSH CUTTER

---

191713 - BCSTAN60\_TEETH

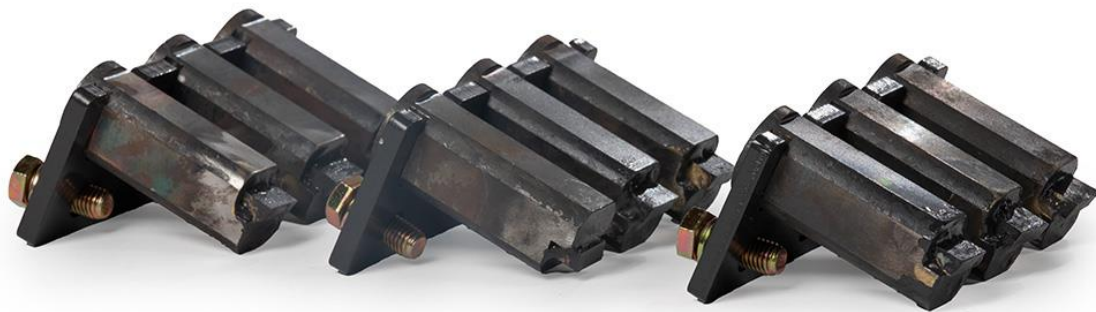

## Operator's Manual

Read the Operator's Manual entirely. When you see this symbol, the subsequent instructions and warnings are serious follow without exception. Your life and the lives of others depend on it!

**REPLACEMENT TEETH - PARTS DIAGRAM / EXPLODED VIEW**

---



KEY	PART NUMBER	DESCRIPTION	QTY
(1)	MD-4H-7	Mulching Teeth	9
(2)	GB/T95-1985	Flat Washer 12	9
(3)	GB/T93-1987	Spring Washer 12	9
(4)	GB/T5783-2000	Hex Bolt M12x30	9
(5)	MD-4H-6	Mulching Teeth Mounting Plate	3

**BLADE HOLDER - PARTS DIAGRAM / EXPLODED VIEW**

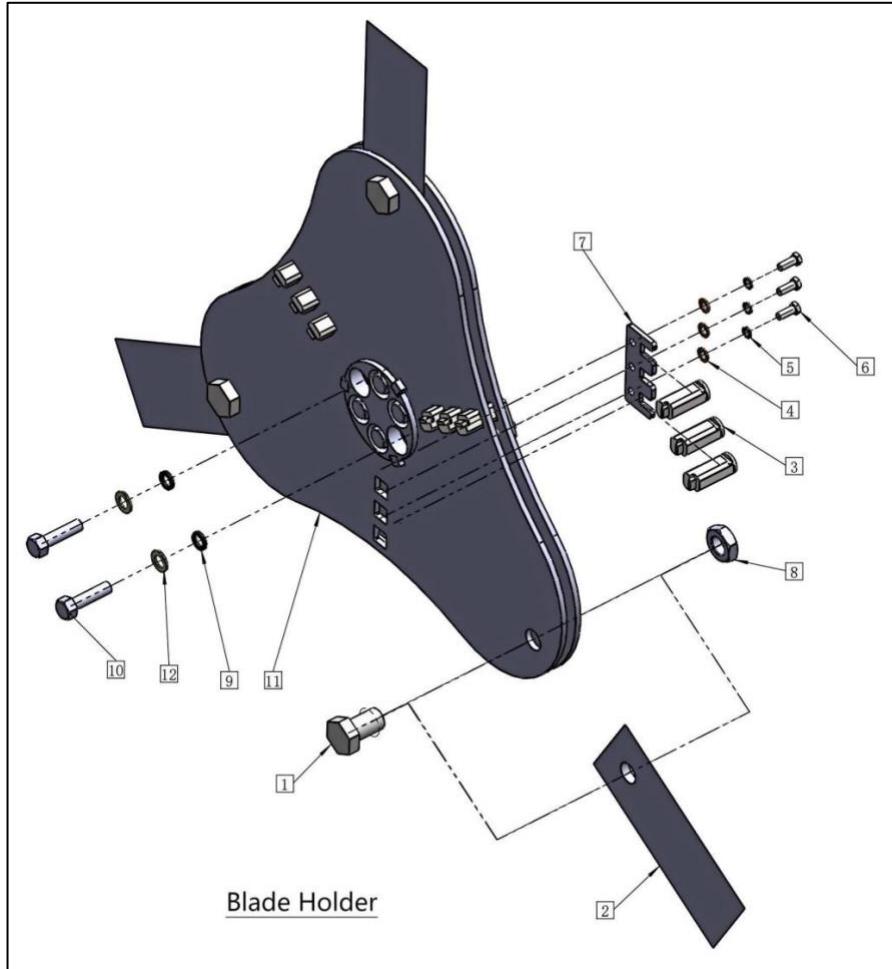

KEY	PART NUMBER	DESCRIPTION	QTY
(1)	MD-4H-5	Blade Bolt	3
(2)	MD-4H-1	Blade	3
(3)	MD-4H-7	Mulching Teeth	9
(4)	GB/T95-1985	Flat Washer 12	9
(5)	GB/T93-1987	Spring Washer 12	9
(6)	GB/T5783-2000	Hex Bolt M12x30	9
(7)	MD-4H-6	Mulching Teeth Mounting Plate	3
(8)	GB/T 6172.1-2000	Hex Nut M36	3
(9)	GB/T93-1987	Spring Washer 20	6
(10)	ANSI Inch 10.8	Hex Bolt 3/4-10UNC	6
(11)	MD-4H-10	Blade Holder	1
(12)	GB/T97.1-2002	Flat Washer 20	6

## BLADE REPLACEMENT

---

### Step 1:

- Grind off the welds seams on Blade Bolt(1) and Blade Holder(11).
- Use a wrench to unscrew Blade Bolt(1), remove Blade(2) and Hex Nut M36(8)

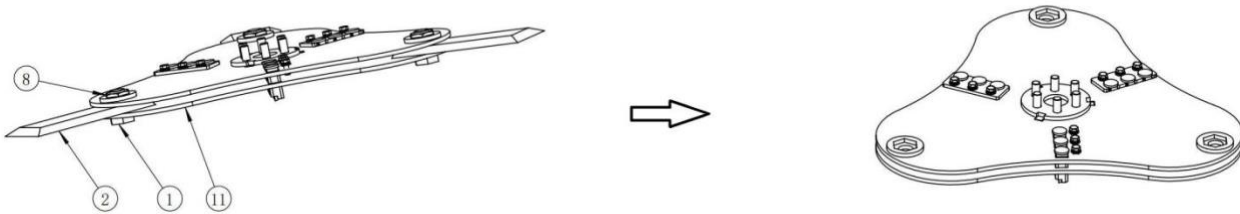

### Step 2:

- Reinstall existing Hex Nut M36(8) into the slot of the Blade Holder(11)
- Reinstall existing Blade Bolt(1) that passing through the Blade Holder(11) and new Blade(2).
- Fasten securely Blade Bolt(1) with Hex Nut M36(8).

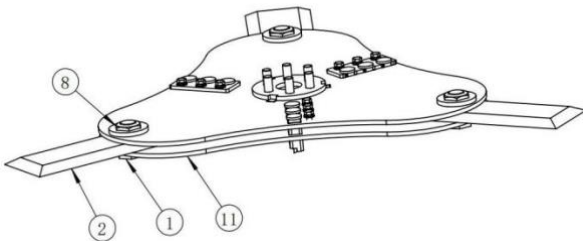

### Step 3:

- Weld three faces of Blade Bolt(1) with Blade Holder(11)

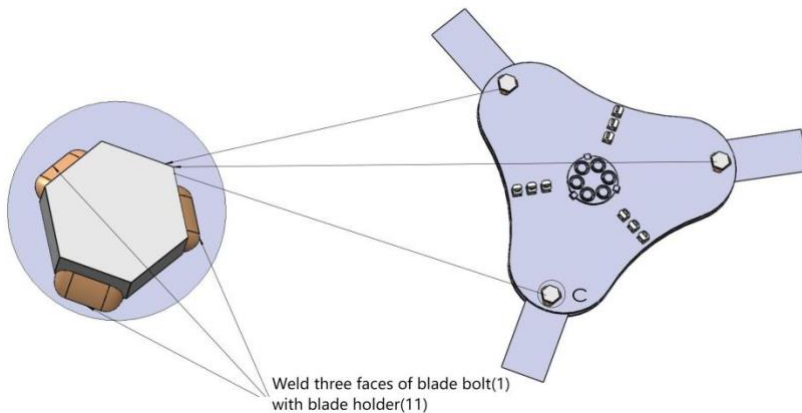

## MULCHING TEETH REPLACEMENT

### Step 1:

- Loosen and remove Hex Bolt M12x30 (6), remove Flat Washer 12 (4) and Spring Washer 12 (5).

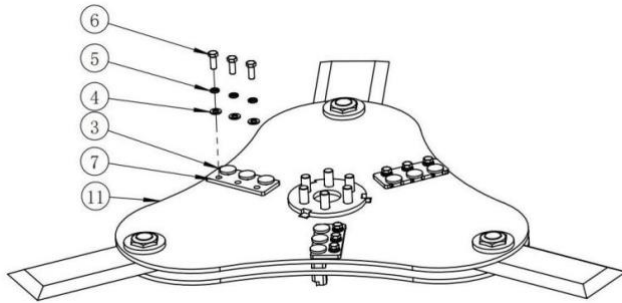

### Step 2:

- Take off Mulching Teeth (3) from the slot of Blade Holder (11) and remove the Mulching Teeth (3) from Teeth Mounting Plate (7).

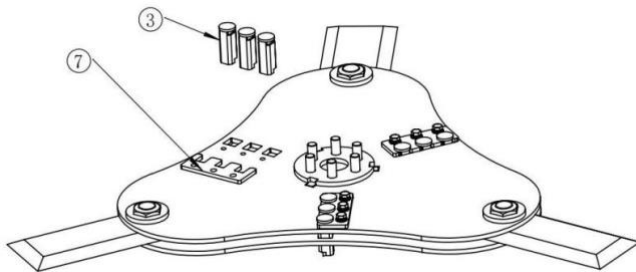

### Step 3:

- Insert new Mulching Teeth (3) into the slot of Blade Holder (11), and insert Teeth Mounting Plate (7) into the slot of teeth.
- Fasten securely Teeth Mounting Plate (7) to Blade Holder (11) by using Flat Washer 12 (4), Spring Washer 12(5), Hex Bolt M12x30 (6).

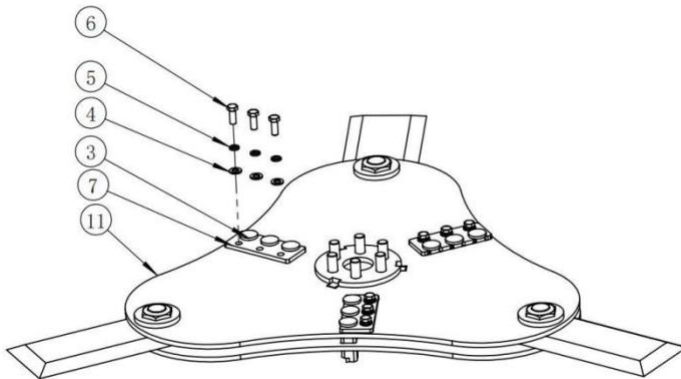

## BLADE HOLDER REPLACEMENT

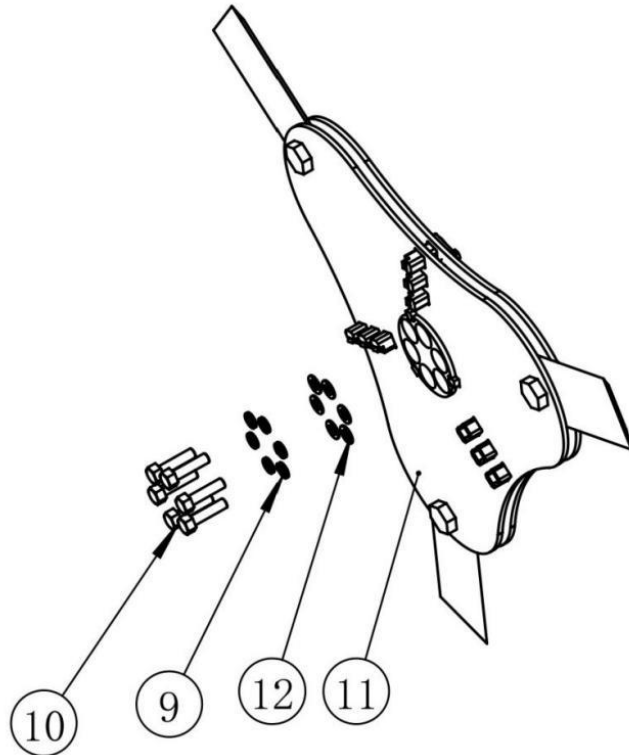

### Step 1:

- Use overhead hoist to lift the Brush Cutter
- Rest the Brush Cutter on fork blades or other robust support.
  - (Make sure that the Brush Cutter is safely secured and would not move during disassembling and reassembling).

### Step 2:

- Unscrew the Hex Bolt 3/4(10) that connect Blade Holder (11) with Bearing Adapter of the Brush Cutter.
- Remove the Hex Bolt 3/4(10), Flat Washer 20 (12) and Spring Washer 20 (9)
- Use overhead hoist to lift the Brush Cutter Main Frame and leave the Blade Holder (11) on the support.

### Step 3:

- Use overhead hoist to lift the Brush Cutter Main Frame back to reassembling Blade holder (11)
- Reinstall existing Flat Washer 20(12), Spring Washer 20 (9), Hex Bolt  $\frac{3}{4}$  (10) to Blade Holder (11) and Bearing Adapter of the Brush Cutter.
- Fasten securely Hex Bolt 3/4(10) to make sure Blade Holder (11) reassembling with Bearing Adapter of the Brush Cutter correctly.

## TROUBLE SHOOTING

Problem	Possible Causes	Remedy
Blade holder does not spin when auxiliary hydraulic is engaged	Hydraulic lines disconnected.	Check hoses and fitting and make sure that they are connected properly.
	Bearing adapter or hydraulic motor failure	Contact customer service for repair or replacement
Blades holder spinning too slowly	Hydraulic flow is reversed.	Check hoses and fitting. Repair or replace.
	Hydraulic leaks.	Contact customer service for repair replace.
	Bearing adapter or hydraulic motor failure.	
Cutter bogs down easily.	Too much debris or wire jams under deck.	Remove and clear clogs.
	Blade speed too slow or skid steer speed too fast.	Increase engine RPM and reduce skid steer speed.
	Inadequate hydraulic oil flow or oil level drops quickly.	Check oil leaks in brush cutter or skid steer and repair
	Bearing adapter failure. Observe exceptional noises or vibrations.	Contact customer service for repair or replace
	Hydraulic motor failure. Observe exceptional noises in hydraulic motor.	Contact customer service for repair or replace
Excessive vibration.	Hardware loosening.	Inspect hardware to check for loosening and tighten
	Loosen, broken or fall off blades.	Repair or replace blades.
	Blade holder damaged.	Repair or replace blade holder.
	Bearing adapter failure.	Contact customer service for repair or replace.

## ACKNOWLEDGEMENT OF RISK AND RELEASE OF LIABILITY

---

The use of any equipment, including this one, involves the potential risk of injury. Apart from any warranty claim that might be presented for a claimed defect in material or workmanship of the product, you accept and assume full responsibility for any and all injuries, damages (both economic and non-economic), and losses of any type, which may occur, and you fully and forever release and discharge Titan, its insurers, employees, officers, directors, associates, and agents from any and all claims, demands, damages, rights of action, or causes of action, present or future, whether the same be known or unknown, anticipated, or unanticipated, resulting from or arising out of the use of said equipment.

This equipment must be used with care by capable and competent individuals under supervision, if necessary.

## WARNING

---



**Do not overfill!** Mower should be level when checking oil in gear box.



some activities might be able to cause electric shock



Sharp objects may be involved.  
Use protective cover during maintenance.

## TITAN LIMITED WARRANTY: TERMS, EXCLUSIONS AND LIMITATIONS OF REMEDIES

---

This product comes with a one (1) year limited warranty that can be found at [www.palletforks.com/warranty.html](http://www.palletforks.com/warranty.html). Please review the same for all details regarding the Titan Limited Warranty.

**THE TITAN LIMITED WARRANTY FOUND AT [WWW.PALLETFORKS.COM/WARRANTY.HTML](http://WWW.PALLETFORKS.COM/WARRANTY.HTML) IS EXCLUSIVE AND IS IN LIEU OF ALL OTHER WARRANTIES, EXPRESS OR IMPLIED, INCLUDING ANY IMPLIED WARRANTY OF MERCHANTABILITY AND/OR FITNESS FOR A PARTICULAR PURPOSE, EACH OF WHICH IS HEREBY DISCLAIMED.**





**NEED HELP? CONTACT US FIRST.**

**1-800-605-7595**

[info@palletworks.com](mailto:info@palletworks.com)  
[www.palletforks.com](http://www.palletforks.com)

© 2025 Titan Brands